

Soils Map

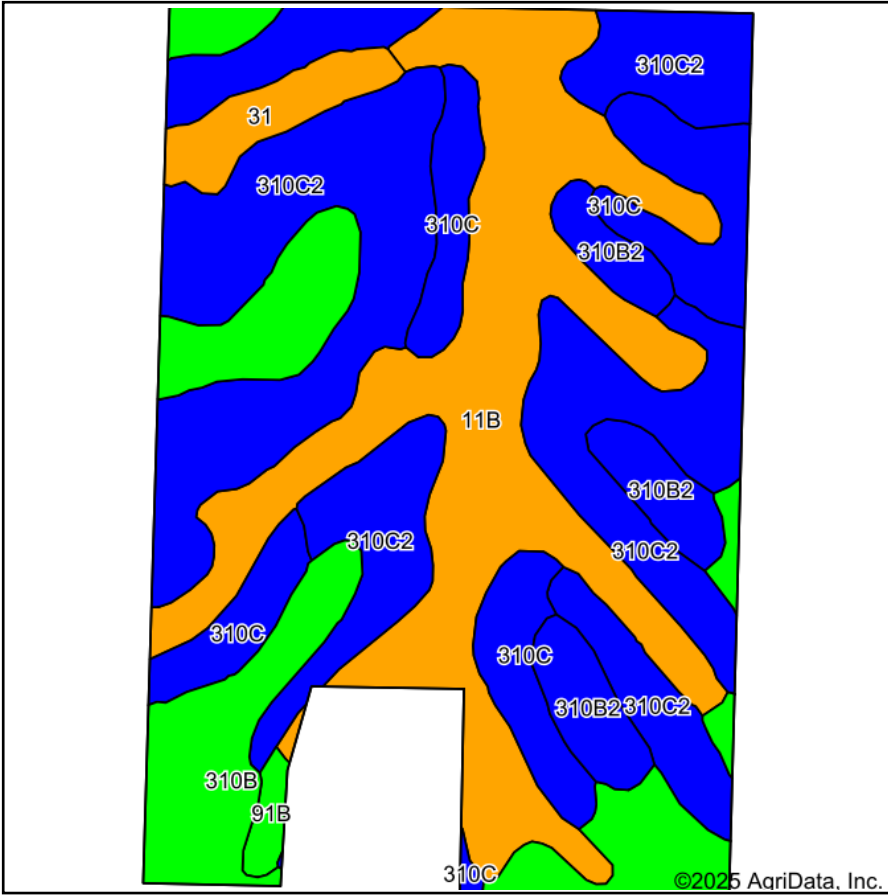

Soils data provided by USDA and NRCS.

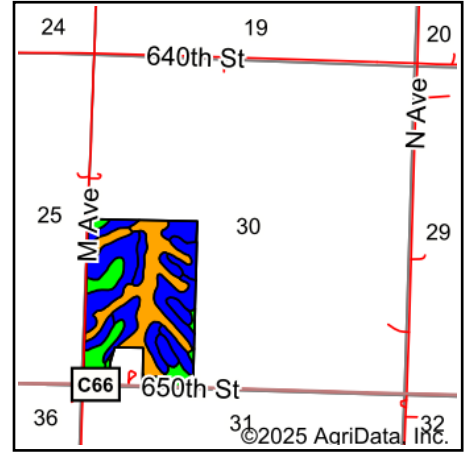

State: **Iowa**
 County: **Cherokee**
 Location: **30-90N-40W**
 Township: **Silver**
 Acres: **99.35**
 Date: **2/26/2025**



Maps Provided By:



© AgriData, Inc. 2023

www.AgriDataInc.com



Area Symbol: IA035, Soil Area Version: 34

Code	Soil Description	Acres	Percent of field	CSR2 Legend	Non-Irr Class *c	CSR2**	CSR	*n NCCPI Soybeans	
310C2	Galva silty clay loam, 5 to 9 percent slopes, eroded	35.94	36.1%		IIIe	84	54	65	
11B	Colo-Judson silty clay loams, 0 to 5 percent slopes, occasionally flooded	27.09	27.3%		IIw	80	59	81	
310B	Galva silty clay loam, 2 to 5 percent slopes	15.29	15.4%		Ile	95	71	75	
310C	Galva silty clay loam, 5 to 9 percent slopes	11.76	11.8%		IIIe	87	56	76	
310B2	Galva silty clay loam, 2 to 5 percent slopes, eroded	5.75	5.8%		Ile	90	69	67	
31	Afton silty clay loam, 0 to 2 percent slopes, occasionally flooded	2.77	2.8%		IIw	80	73	68	
91B	Primghar silty clay loam, 2 to 5 percent slopes	0.75	0.8%		Ile	95	79	78	
Weighted Average						2.48	85.3	59.8	*n 72.5

**IA has updated the CSR values for each county to CSR2.

*n: The aggregation method is "Weighted Average using all components"

*c: Using Capabilities Class Dominant Condition Aggregation Method

Soils data provided by USDA and NRCS.