

Soils Map

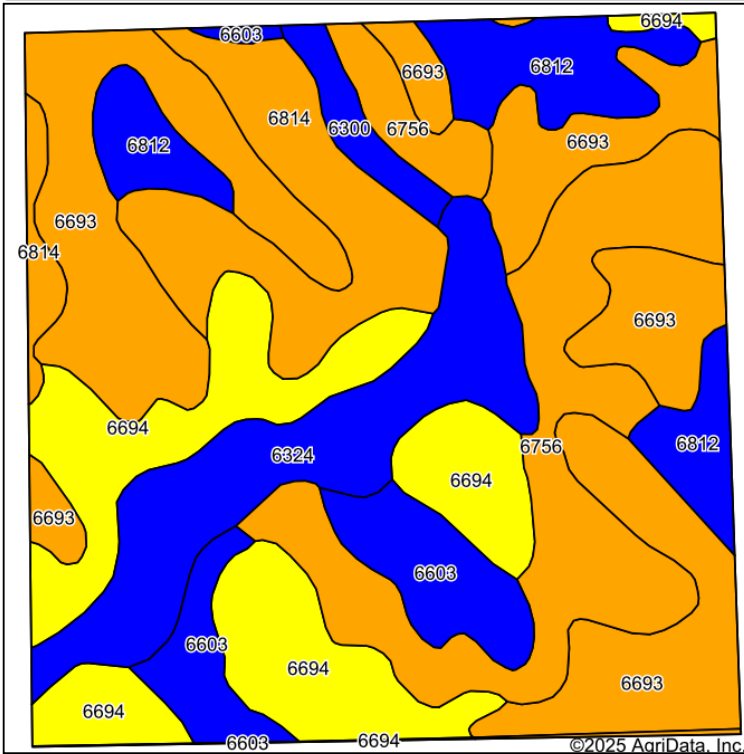

Soils data provided by USDA and NRCS.

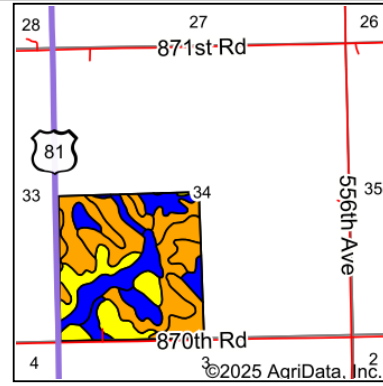

State: **Nebraska**
 County: **Cedar**
 Location: **34-29N-1W**
 Township: **Precinct 18**
 Acres: **154.54**
 Date: **4/1/2025**









Maps Provided By:
surety
 CUSTOMIZED ONLINE MAPPING
 © AgriData, Inc. 2023 www.AgriDataInc.com



Area Symbol: NE027, Soil Area Version: 24
 Area Symbol: NE139, Soil Area Version: 23

Code	Soil Description	Acres	Percent of field	Non-Irr Class Legend	Non-Irr Class *c	Irr Class *c	SRPG	Alfalfa hay Tons	Alfalfa hay Irrigated Tons	Corn Bu	Corn Irrigated Bu	Oats Bu	Smooth bromegrass AUM	Smooth bromegrass Irrigated AUM	Soybeans Bu	Soybeans Irrigated Bu	*n NCCPI Soybeans
6693	Crofton-Nora complex, 2 to 6 percent slopes, eroded	40.63	26.2%		IIIe	IIIe	61										67
6694	Crofton-Nora complex, 6 to 11 percent slopes, eroded	28.79	18.6%		IVe	IVe	57										64
6756	Nora silt loam, 6 to 11 percent slopes, eroded	25.93	16.8%		IIIe	IVe	64										66
6324	Coleridge silty clay loam, 0 to 2 percent slopes, occasionally flooded	17.14	11.1%		IIw	IIw	67										74

Soils data provided by USDA and NRCS.

Code	Soil Description	Acres	Percent of field	Non-Irr Class Legend	Non-Irr Class *c	Irr Class *c	SRPG	Alfalfa hay Tons	Alfalfa hay Irrigated Tons	Corn Bu	Corn Irrigated Bu	Oats Bu	Smooth brome grass AUM	Smooth brome grass Irrigated AUM	Soybeans Bu	Soybeans Irrigated Bu	*n NCCPI Soybeans
6814	Moody silty clay loam, 6 to 11 percent slopes, eroded	16.21	10.5%		IIIe	IVe	67										61
6812	Moody silty clay loam, 2 to 6 percent slopes, eroded	12.87	8.3%		Ile	IIIe	71										64
6603	Alcester silty clay loam, 2 to 6 percent slopes	9.98	6.5%		Ile	IIIe											72
6300	Aowa silt loam, 0 to 3 percent slopes, occasionally flooded	2.62	1.7%		IIw	IIw	58	4	5	86	126	68	5	10	34	41	76
6693	Crofton-Nora complex, 2 to 6 percent slopes, eroded	0.28	0.2%		IIIe	IIIe	58										67
6694	Crofton-Nora complex, 6 to 11 percent slopes, eroded	0.09	0.1%		IVe	IVe	53										64
Weighted Average					2.91	3.33	58.9	0.1	0.1	1.5	2.1	1.2	0.1	0.2	0.6	0.7	*n 66.6

*n: The aggregation method is "Weighted Average using all components"

*c: Using Capabilities Class Dominant Condition Aggregation Method