

# Soils Map

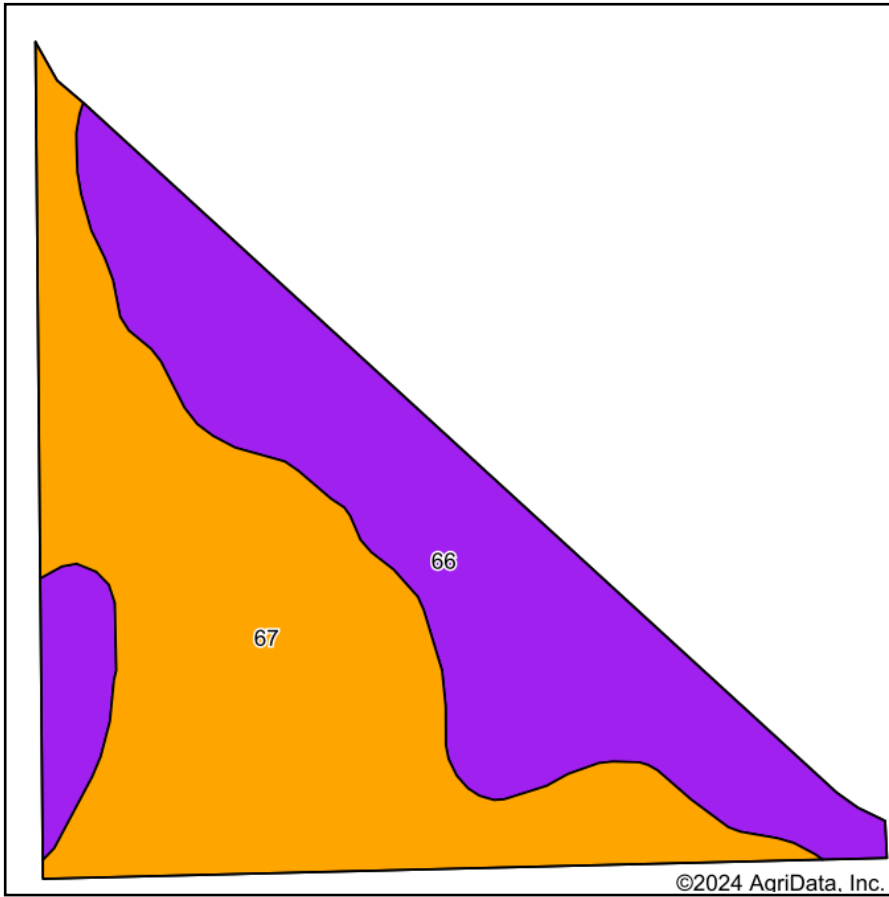

Soils data provided by USDA and NRCS.

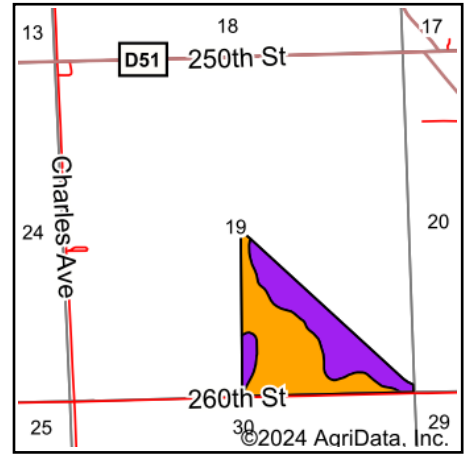

State: **Iowa**  
 County: **Woodbury**  
 Location: **19-87N-46W**  
 Township: **Grange**  
 Acres: **80.11**  
 Date: **11/5/2024**



Maps Provided By:



Area Symbol: IA193, Soil Area Version: 33

Code	Soil Description	Acres	Percent of field	CSR2 Legend	Non-Irr Class *c	CSR2**	CSR	*n NCCPI Soybeans
67	Woodbury silty clay, 0 to 2 percent slopes, rarely flooded	44.09	55.0%		Illw	74	51	52
66	Luton silty clay, 0 to 2 percent slopes, rarely flooded	36.02	45.0%		Illw	59	37	49
<b>Weighted Average</b>					<b>3.00</b>	<b>67.3</b>	<b>44.7</b>	<b>*n 50.7</b>

\*\*IA has updated the CSR values for each county to CSR2.

\*n: The aggregation method is "Weighted Average using all components"

\*c: Using Capabilities Class Dominant Condition Aggregation Method