



Owners

| | | |
|---|------------------------|------------------------|
| <p>Primary Owner (Deed Holder) Hoffman, Robert L & Eliese A 23398 Jade Av Merrill, IA 51038</p> | <p>Secondary Owner</p> | <p>Mailing Address</p> |
|---|------------------------|------------------------|

Summary

| | |
|-------------------------|---|
| Parcel ID | 18-10-101-001 |
| Alternate ID | 1810101001 |
| Property Address | |
| Sec/Twp/Rng | 10-91-46 |
| Brief Legal Description | PT NW 1/4 NW 1/4 <i>(Note: Not to be used on legal documents)</i> |
| Document(s) | DEC: 2012-6299 (2012-12-13) DED: 2005-4162 (2005-08-23) |
| Gross Acres | 30.25 |
| Exempt Acres | N/A |
| Net Acres | 30.25 |
| CSR | 1688.01 |
| Class | A - Agriculture <i>(Note: This is for tax purposes only. Not to be used for zoning.)</i> |
| Tax District | PLYMOUTH TWP/LE MARS SCH |
| School District | LE MARS SCHOOL |



Land

Lot Area 30.25 Acres ; 1,317,690 SF

Agricultural Buildings

| Plot # | Type | Description | Width | Length | Year Built |
|--------|------------------------------|---------------------------------|-------|--------|------------|
| | Steel Utility Building | FR | 60 | 120 | 2005 |
| | Steel Utility Building | MACHINE | 60 | 120 | 2009 |
| | Silage Trench/Bunker | BUNKER GRAIN STORAGE | 60 | 120 | 2011 |
| | Steel Utility Building | QUONSET ON BUNKER | 60 | 120 | 2011 |
| | Bin - Grain Storage (Bushel) | O.H. STORAGE BIN W/ CONE BOTTOM | 0 | 0 | 1975 |
| | Bin - Grain Storage (Bushel) | GRAIN BIN | 30 | 44 | 2015 |

Soils Report

| Soil Type | Soil Description | Acres | CSR | CSR Points |
|-----------|-------------------------------|---------------------------|---------------------------|-----------------------------------|
| 12C | Napier silt loam | 10.58 | 89.00 | 941.62 |
| 18B | McPaul-Kennebec silt loams | 1.02 | 75.00 | 76.50 |
| 1C3 | Ida silt loam severely eroded | 2.80 | 58.00 | 162.40 |
| 1D3 | Ida silt loam severely eroded | 12.57 | 32.00 | 402.24 |
| 18B | McPaul-Kennebec silt loams | 0.02 | 75.00 | 1.50 |
| 1D3 | Ida silt loam severely eroded | 3.26 | 32.00 | 104.32 |
| | | Total Acres: 30.25 | Average CSR: 55.82 | Total CSR Points: 1,688.58 |

Yard Extras

BATHROOM
GRAIN LEG
Dump Pit
O.H. BIN STL SUPPORT STRUCTURE

Sales

| Date | Seller | Buyer | Recording | Sale Condition - NUTC | Type | Multi Parcel | Amount |
|----------|--------|-------|-----------|------------------------|------|--------------|--------|
| 1/4/2012 | | | 2012-6299 | Other with explanation | Deed | | \$0.00 |

There are other parcels involved in one or more of the above sales:

- [Recording: 2012-6299 - Parcel: 18-10-101-002](#)
- [Recording: 2012-6299 - Parcel: 18-10-101-003](#)
- [Recording: 2012-6299 - Parcel: 18-10-101-004](#)
- [Recording: 2012-6299 - Parcel: 18-10-101-005](#)
- [Recording: 2012-6299 - Parcel: 18-10-101-006](#)
- [Recording: 2012-6299 - Parcel: 18-10-101-007](#)
- [Recording: 2012-6299 - Parcel: 18-10-126-001](#)
- [Recording: 2012-6299 - Parcel: 18-10-126-002](#)

[Recording: 2012-6299 - Parcel: 18-10-126-003](#)
[Recording: 2012-6299 - Parcel: 18-10-126-004](#)
[Recording: 2012-6299 - Parcel: 18-10-126-005](#)
[Recording: 2012-6299 - Parcel: 18-10-126-006](#)
[Recording: 2012-6299 - Parcel: 18-10-126-007](#)
[Recording: 2012-6299 - Parcel: 18-10-126-008](#)
[Recording: 2012-6299 - Parcel: 18-10-126-009](#)
[Recording: 2012-6299 - Parcel: 18-10-126-010](#)
[Recording: 2012-6299 - Parcel: 18-10-126-011](#)
[Recording: 2012-6299 - Parcel: 18-10-151-001](#)
[Recording: 2012-6299 - Parcel: 18-10-151-002](#)
[Recording: 2012-6299 - Parcel: 18-10-151-003](#)
[Recording: 2012-6299 - Parcel: 18-10-151-004](#)
[Recording: 2012-6299 - Parcel: 18-10-151-005](#)
[Recording: 2012-6299 - Parcel: 18-10-176-001](#)
[Recording: 2012-6299 - Parcel: 18-10-176-002](#)
[Recording: 2012-6299 - Parcel: 18-10-176-003](#)
[Recording: 2012-6299 - Parcel: 18-10-176-004](#)

Permits

| Permit # | Date | Description | Amount |
|----------|------------|-------------|--------|
| | 04/15/2015 | New Bldg | 30,000 |
| | 08/25/2011 | New Bldg | 50,000 |
| | 09/11/2008 | New Bldg | 35,000 |

Valuation

| | 2021 | 2020 | 2019 | 2018 | 2017 | 2016 |
|------------------------|-------------|-------------|-------------|-------------|-------------|-------------|
| Classification | Agriculture | Agriculture | Agriculture | Agriculture | Agriculture | Agriculture |
| + Land | \$36,790 | \$35,110 | \$35,110 | \$44,130 | \$44,130 | \$52,020 |
| + Building | \$91,430 | \$81,260 | \$81,260 | \$106,670 | \$106,670 | \$147,320 |
| = Total Assessed Value | \$128,220 | \$116,370 | \$116,370 | \$150,800 | \$150,800 | \$199,340 |

Taxation

| | 2019 Pay 2020-2021 | 2018 Pay 2019-2020 | 2017 Pay 2018-2019 | 2016 Pay 2017-2018 |
|-----------------------------------|-----------------------|-----------------------|-----------------------|-----------------------|
| Classification | Agriculture | Agriculture | Agriculture | Agriculture |
| Taxable Value | \$94,822 | \$84,647 | \$82,108 | \$94,685 |
| x Levy Rate (per \$1000 of value) | | | | |
| = Gross Taxes Due | | | | |
| - Credits | (\$20.14) | (\$21.64) | (\$25.06) | (\$26.26) |
| = Net Taxes Due | \$1,884.00 | \$1,708.00 | \$1,732.00 | \$1,984.00 |

Pay Property Taxes

[Click here to pay property taxes for this parcel.](#)

Tax History

| Year | Due Date | Amount | Paid | Date Paid | Receipt |
|------|----------------|---------|------|------------|---------|
| 2019 | March 2021 | \$942 | Yes | 2020-10-29 | 7873 |
| | September 2020 | \$942 | Yes | 2020-10-29 | |
| 2018 | March 2020 | \$854 | Yes | 2020-04-22 | 7853 |
| | September 2019 | \$854 | Yes | 2019-09-26 | |
| 2017 | March 2019 | \$866 | Yes | 2019-04-17 | 7841 |
| | September 2018 | \$866 | Yes | 2018-09-27 | |
| 2016 | March 2018 | \$992 | Yes | 2018-03-31 | 7797 |
| | September 2017 | \$992 | Yes | 2017-10-31 | |
| 2015 | March 2017 | \$912 | Yes | 2017-05-25 | 7772 |
| | September 2016 | \$912 | Yes | 2016-09-29 | |
| 2014 | March 2016 | \$1,110 | Yes | 2016-03-31 | 7736 |
| | September 2015 | \$1,110 | Yes | 2015-09-30 | |

Homestead Tax Credit Application

[Apply online for the Iowa Homestead Tax Credit](#)

Military Tax Exemption Application

[Apply online for the Iowa Military Tax Credit](#)

Photos



Sketches

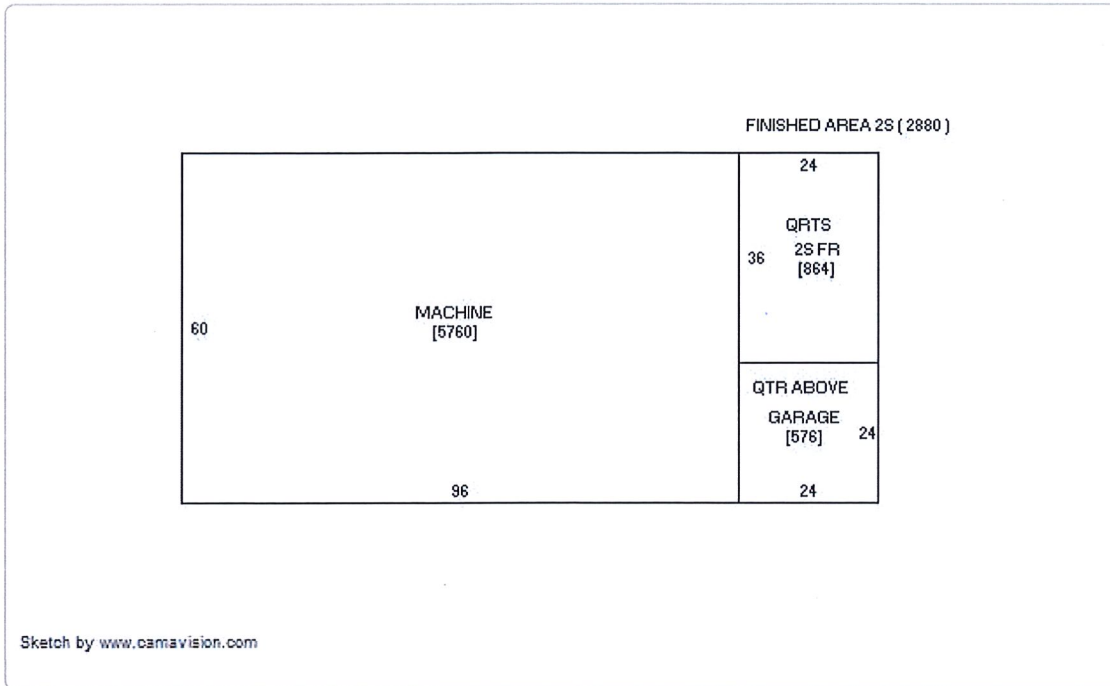

Vanguard Info Link



[Click here to visit the Assessor's VCS information page](#)

No data available for the following modules: Doing Business As, Residential Dwellings, Commercial Buildings, Tax Sale, Iowa Land Records.

The Plymouth County Assessors Office makes every effort to produce the most accurate information possible. No warranties, expressed or implied are provided for the data herein, its use or interpretation. The assessment information is from the last certified assessment roll. All other data is subject to change.

[User Privacy Policy](#)
[GDPR Privacy Notice](#)

Last Data Upload: [4/7/2021, 8:34:02 PM](#)

Version 2.3.115

Developed by
 Schneider
 GEOSPATIAL