

# Soils Map

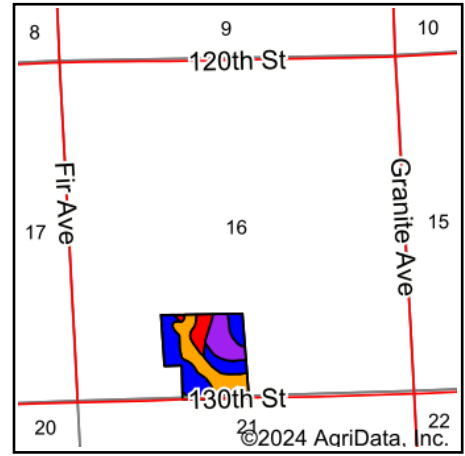

State: **Iowa**  
 County: **Plymouth**  
 Location: **16-93N-47W**  
 Township: **Preston**  
 Acres: **35.76**  
 Date: **2/14/2024**

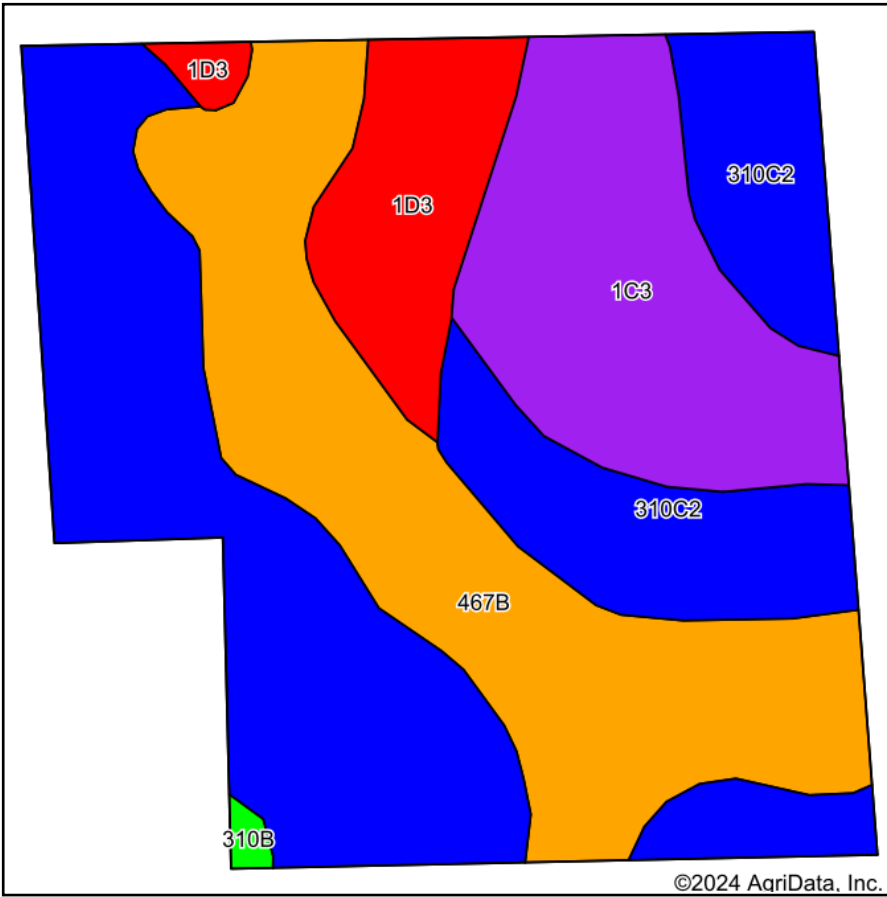

Maps Provided By:



Soils data provided by USDA and NRCS.

©2024 AgriData, Inc.

© AgriData, Inc. 2023

www.AgriDataInc.com

Area Symbol: IA149, Soil Area Version: 34

Code	Soil Description	Acres	Percent of field	CSR2 Legend	Non-Irr Class *c	CSR2**	CSR	*n NCCPI Soybeans	
310C2	Galva silty clay loam, 5 to 9 percent slopes, eroded	15.65	43.8%		IIIe	84	51	65	
467B	Radford silty clay loam, 2 to 5 percent slopes	10.21	28.6%		IIw	75	72	77	
1C3	Ida silt loam, 5 to 9 percent slopes, severely eroded	6.50	18.2%		IIIe	58	44	61	
1D3	Ida silt loam, 9 to 14 percent slopes, severely eroded	3.26	9.1%		IIIe	32	35	58	
310B	Galva silty clay loam, 2 to 5 percent slopes	0.14	0.4%		Ile	95	68	75	
<b>Weighted Average</b>						<b>2.71</b>	<b>72</b>	<b>54.3</b>	<b>*n 67.1</b>

\*\*IA has updated the CSR values for each county to CSR2.

\*n: The aggregation method is "Weighted Average using all components"

\*\*IA has updated the CSR values for each county to CSR2.\*c: Using Capabilities Class Dominant Condition Aggregation Method