

# Soils Map

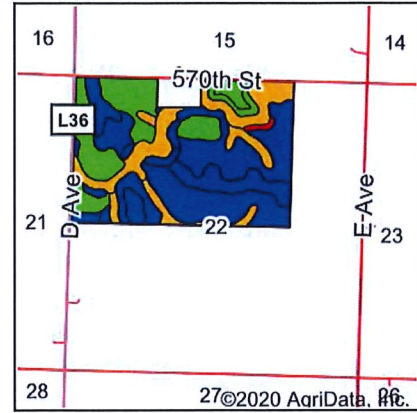

State: **Iowa**  
 County: **Cherokee**  
 Location: **22-91N-42W**  
 Township: **Tilden**  
 Acres: **227.31**  
 Date: **9/30/2020**

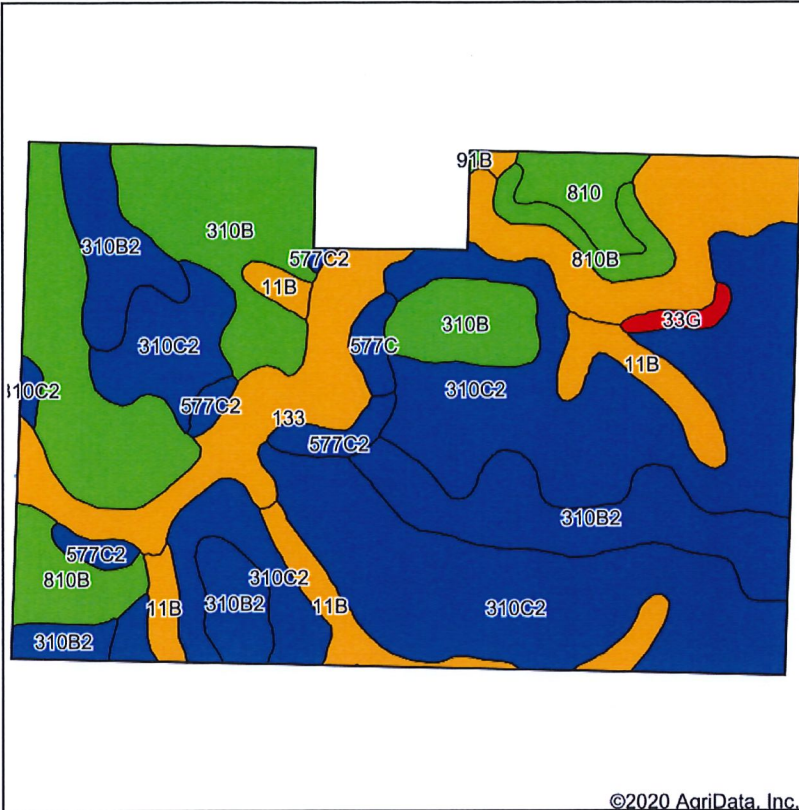

Maps Provided By: **surety**  
 CUSTOMIZED ONLINE MAPPING  
 © AgriData, Inc. 2020 www.AgriDataInc.com



Soils data provided by USDA and NRCS.

©2020 AgriData, Inc.

Area Symbol: IA035, Soil Area Version: 30

Code	Soil Description	Acres	Percent of field	CSR2 Legend	Non-Irr Class *c	CSR2**	CSR	*n NCCPI Soybeans
310C2	Galva silty clay loam, 5 to 9 percent slopes, eroded	89.05	39.2%	Blue	IIIe	84	54	66
310B	Galva silty clay loam, 2 to 5 percent slopes	39.71	17.5%	Green	Ile	95	71	76
133	Colo silty clay loam, deep loess, 0 to 2 percent slopes, occasionally flooded	30.81	13.6%	Orange	IIw	78	74	80
310B2	Galva silty clay loam, 2 to 5 percent slopes, eroded	30.11	13.2%	Dark Blue	Ile	90	69	68
11B	Colo-Judson silty clay loams, 0 to 5 percent slopes, occasionally flooded	14.29	6.3%	Light Orange	IIw	80	59	81
810B	Galva silty clay loam, terrace, 2 to 5 percent slopes	9.80	4.3%	Light Green	Ile	95	71	76
810	Galva silty clay loam, terrace, 0 to 2 percent slopes	4.82	2.1%	Light Green	I	100	76	78
577C2	Everly clay loam, 5 to 9 percent slopes, moderately eroded	4.73	2.1%	Dark Blue	IIIe	83	49	65
577C	Everly clay loam, 5 to 9 percent slopes	1.86	0.8%	Dark Blue	IIIe	86	51	74
33G	Steinauer clay loam, 25 to 40 percent slopes	1.32	0.6%	Red	VIIe	5	5	8
810C2	Galva silty clay loam, terrace, 5 to 9 percent slopes, eroded	0.69	0.3%	Dark Blue	IIIe	84	54	65
91B	Primghar silty clay loam, 2 to 5 percent slopes	0.12	0.1%	Light Green	Ile	95	79	78
<b>Weighted Average</b>						<b>86</b>	<b>62.8</b>	<b>*n 71.2</b>

\*\*IA has updated the CSR values for each county to CSR2.  
 \*n: The aggregation method is "Weighted Average using all components"  
 \*c: Using Capabilities Class Dominant Condition Aggregation Method

Soils data provided by USDA and NRCS.