

Soils Map

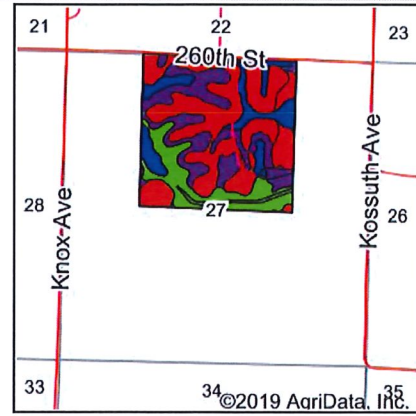

State: **Iowa**
 County: **Woodbury**
 Location: **27-87N-44W**
 Township: **Grant**
 Acres: **153.97**
 Date: **1/14/2020**

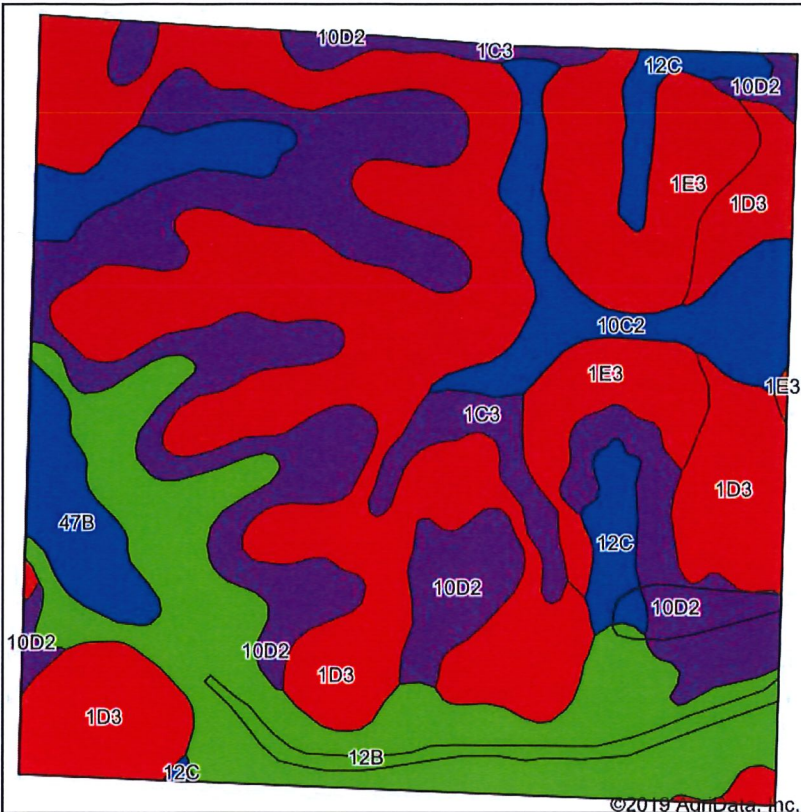

Maps Provided By:



Soils data provided by USDA and NRCS.

Area Symbol: IA193, Soil Area Version: 29

Code	Soil Description	Acres	Percent of field	CSR2 Legend	Non-Irr Class *c	CSR2**	CSR	*n NCCPI Soybeans
1D3	Ida silt loam, 9 to 14 percent slopes, severely eroded	54.07	35.1%	■	IIIe	32	37	47
10D2	Monona silt loam, 9 to 14 percent slopes, eroded	32.28	21.0%	■	IIIe	60	47	67
12B	Napier silt loam, 2 to 5 percent slopes	25.97	16.9%	■	Ile	93	72	85
1E3	Ida silt loam, 14 to 20 percent slopes, severely eroded	15.58	10.1%	■	IVe	18	28	43
47B	Napier-Rawles complex, 2 to 5 percent slopes	8.12	5.3%	■	IIw	85	59	72
10C2	Monona silt loam, 5 to 9 percent slopes, eroded	7.92	5.1%	■	IIIe	86	57	71
1C3	Ida silt loam, 5 to 9 percent slopes, severely eroded	5.34	3.5%	■	IIIe	58	46	49
12C	Napier silt loam, 5 to 9 percent slopes	4.69	3.0%	■	IIIe	89	58	84
Weighted Average						55	47.2	*n 60.9

**IA has updated the CSR values for each county to CSR2.

*n: The aggregation method is "Weighted Average using major components"

*c: Using Capabilities Class Dominant Condition Aggregation Method

Soils data provided by USDA and NRCS.