



# Plymouth County, IA

## Owners

### Primary Owner

(Deed Holder)  
[Rolling, Eilene L](#)  
38625 200 St  
Le Mars, IA 51031

### Secondary Owner

### Mailing Address

## Summary

Parcel ID 13-20-400-002  
 Alternate ID 1320400002  
 Property Address 38625 200 St  
 Le Mars  
 Sec/Twp/Rng 20-92-44  
 Brief Legal Description SW 1/4 SE 1/4  
 (Note: Not to be used on legal documents)  
 Document(s) COT: 2014-3789 (2014-10-14)  
 Gross Acres 39.00  
 Exempt Acres N/A  
 Net Acres 39.00  
 CSR 3481.19  
 Class A - Agriculture  
 (Note: This is for tax purposes only. Not to be used for zoning.)  
 Tax District MARION TWP LE MARS SCH  
 School District LE MARS SCHOOL



## Land

Lot Area 39.00 Acres ; 1,698,840 SF

## Residential Dwellings

Residential Dwelling  
 Occupancy Single-Family / Owner Occupied  
 Style 2 Story Frame  
 Architectural Style N/A  
 Year Built 1819  
 Exterior Material Vinyl  
 Total Gross Living Area 2,040 SF  
 Attic Type None;  
 Number of Rooms 7 above; 0 below  
 Number of Bedrooms 3 above; 0 below  
 Basement Area Type 1/2  
 Basement Area 834  
 Basement Finished Area  
 Plumbing 1 Full Bath;  
 Central Air Yes  
 Heat FHA - Gas  
 Fireplaces  
 Porches  
 Decks Wood Deck-Med (144 SF);  
 Additions 1 Story Frame (432 SF) (432 Bsmt SF);  
 Garages

## Agricultural Buildings

Plot #	Type	Description	Width	Length	Year Built
	Barn - Flat	FR	52	64	1940
	Feeder Bunk	CONC	0	0	1975
	Machine or Utility Building	FR	28	70	1949
	Swine Finish and Farrow (Old Style)	FR	20	70	1940
	Bin - Wire Grain Storage	WIRE/STL	12	20	1964
	Bin - Grain Storage (Bushel)	STL	0	0	1930
	Bin - Grain Storage (Bushel)	STL	0	0	1930
	Bin - Grain Storage (Bushel)	STL	0	0	1978
	Swine Finish and Farrow (Old Style)	FR	24	48	1940

## Soils Report

Soil Type	Soil Description	Acres	CSR	CSR Points
467B	Radford silty clay loam	0.68	75.00	51.00
91B	Primghar silty clay loam	3.98	95.00	378.10
310B	Galva silty clay loam	26.53	95.00	2,520.35
310C2	Galva silty clay loam	4.04	84.00	339.36
310B	Galva silty clay loam	3.65	95.00	346.75
310C2	Galva silty clay loam	0.12	84.00	10.08
		<b>Total Acres: 39.00</b>	<b>Average CSR: 93.48</b>	<b>Total CSR Points: 3,645.64</b>

## Sales

Date	Seller	Buyer	Recording	Sale Condition - NUTC	Type	Multi Parcel	Amount
9/3/2014	ROLLING, GERALD E ESTATE	ROLLING, EILENE L	2014-3789	Exchange, trade, gift, transfer from Estate (Including 1031 Exchanges)	Deed		\$0.00

⊞ There are other parcels involved in one or more of the above sales:

[Recording: 2014-3789 - Parcel: 13-20-400-001](#)

[Recording: 2014-3789 - Parcel: 13-20-400-004](#)

## Valuation

	2022	2021	2020	2019	2018
Classification	Agriculture	Agriculture	Agriculture	Agriculture	Agriculture
+ Land	\$70,060	\$70,060	\$72,360	\$72,360	\$95,760
+ Dwelling	\$104,560	\$104,560	\$92,420	\$92,420	\$85,020
+ Building	\$5,850	\$5,850	\$5,200	\$5,200	\$6,830
= Total Assessed Value	<b>\$180,470</b>	<b>\$180,470</b>	<b>\$169,980</b>	<b>\$169,980</b>	<b>\$187,610</b>

## Taxation

	2020 Pay 2021-2022	2019 Pay 2020-2021	2018 Pay 2019-2020	2017 Pay 2018-2019
Classification	Agriculture	Agriculture	Agriculture	Agriculture
+ Taxable Land Value	\$60,804	\$58,961	\$53,752	\$52,139
+ Taxable Building Value	\$4,370	\$4,237	\$3,834	\$3,719
+ Taxable Dwelling Value	\$52,134	\$50,900	\$48,392	\$47,289
= Gross Taxable Value	<b>\$117,308</b>	<b>\$114,098</b>	<b>\$105,978</b>	<b>\$103,147</b>
- Military Exemption	\$0	\$0	\$0	\$0
= Net Taxable Value	<b>\$117,308</b>	<b>\$114,098</b>	<b>\$105,978</b>	<b>\$103,147</b>
x Levy Rate (per \$1000 of value)	19.79533	19.98444	20.34133	21.29360
= Gross Taxes Due	<b>\$2,322.15</b>	<b>\$2,280.18</b>	<b>\$2,155.73</b>	<b>\$2,196.37</b>
- Ag Land Credit	(\$42.70)	(\$43.69)	(\$46.95)	(\$54.17)
- Disabled and Senior Citizens Credit	\$0.00	\$0.00	\$0.00	\$0.00
- Family Farm Credit	\$0.00	\$0.00	\$0.00	\$0.00
- Homestead Credit	(\$96.01)	(\$96.92)	(\$98.66)	(\$103.27)
- Business Property Credit	\$0.00	\$0.00	\$0.00	\$0.00
- Prepaid Tax	\$0.00	\$0.00	\$0.00	\$0.00
= Net Taxes Due	<b>\$2,184.00</b>	<b>\$2,140.00</b>	<b>\$2,010.00</b>	<b>\$2,038.00</b>

## Pay Property Taxes

[Click here to pay property taxes for this parcel.](#)

## Tax History

Year	Due Date	Amount	Paid	Date Paid	Receipt
2020	March 2022	\$1,092	No		11005
	September 2021	\$1,092	Yes	2021-10-08	
2019	March 2021	\$1,070	Yes	2021-04-04	10958
	September 2020	\$1,070	Yes	2020-09-30	
2018	March 2020	\$1,005	Yes	2020-03-31	10923
	September 2019	\$1,005	Yes	2019-09-30	
2017	March 2019	\$1,019	Yes	2019-03-29	10899
	September 2018	\$1,019	Yes	2018-10-01	
2016	March 2018	\$1,045	Yes	2018-03-16	10845
	September 2017	\$1,045	Yes	2017-09-25	
2015	March 2017	\$1,034	Yes	2017-03-08	10799
	September 2016	\$1,034	Yes	2016-09-14	
2014	March 2016	\$946	Yes	2016-03-10	10746
	September 2015	\$946	Yes	2015-08-24	

## Homestead Tax Credit Application

[Apply online for the Iowa Homestead Tax Credit](#)

## Military Tax Exemption Application

[Apply online for the Iowa Military Tax Credit](#)

### Photos



### Sketches

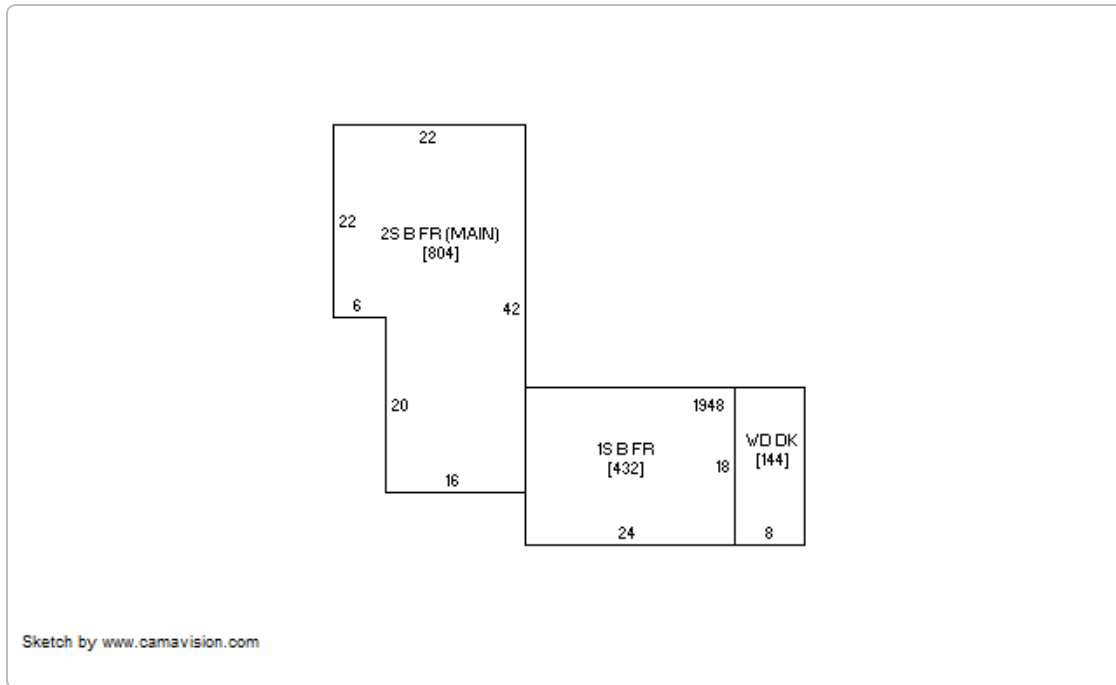

### Vanguard Info Link



[Click here to visit the Assessor's VCS information page](#)

**No data available for the following modules:** Doing Business As, Commercial Buildings, Yard Extras, Permits, Tax Sale.

The Plymouth County Assessors Office makes every effort to produce the most accurate information possible. No warranties, expressed or implied are provided for the data herein, its use or interpretation. The assessment information is from the last certified assessment roll. All other data is subject to change.

[User Privacy Policy](#)  
[GDPR Privacy Notice](#)

Last Data Upload: [4/11/2022, 8:53:19 PM](#)

Version 2.3.186

Developed by  
 Schneider  
GEOSPATIAL