

# Beacon™ Cherokee County, IA

## Summary

**Parcel ID** 1101100002  
**Alternate ID**  
**Property Address** 1828 540th St  
 Cherokee  
**Sec/Twp/Rng** 1-91-40  
**Brief Legal Description** NE NW 1130  
 (Note: Not to be used on legal documents)  
**Document(s)** WD: 1968-01-08 (1968-01-08)  
 TBK: 2A-58  
**Gross Acres** 36.55  
**Exempt Acres** 1.51 (EXM)  
**Net Acres** 35.04  
**CSR** 2743  
**Class** A - Agriculture  
 (Note: This is for tax purposes only. Not to be used for zoning.)  
**Tax District** PILOT TWP CHEROKEE SCHOOL  
**School District** CHEROKEE



## Owners

<b>Primary Owner</b> (Deed Holder) <a href="#">PIP Inc</a> <a href="#">PO Box 884</a> Cherokee, IA 51012-0884	<b>Secondary Owner</b>	<b>Mailing Address</b>
---	------------------------	------------------------

## Land

**Lot Area** 35.04 Acres ; 1,526,342 SF

## Residential Dwellings

**Residential Dwelling**  
**Occupancy** Single-Family / Owner Occupied  
**Style** 1 1/2 Story Frame  
**Architectural Style** N/A  
**Year Built** 1900  
**Exterior Material** Alum  
**Total Gross Living Area** 1,267 SF  
**Attic Type** None;  
**Number of Rooms** 6 above; 0 below  
**Number of Bedrooms** 2 above; 0 below  
**Basement Area Type** None  
**Basement Area** 0  
**Basement Finished Area**  
**Plumbing** 1 Toilet Room; 1 No Bathroom;  
**Central Air** Yes  
**Heat** FHA - Gas  
**Fireplaces**  
**Porches** 1S Frame Enclosed (224 SF); 1S Frame Enclosed (72 SF);  
**Decks**  
**Additions** 1 Story Frame (96 SF);  
 1 Story Frame (464 SF);  
**Garages** 384 SF (16F W x 24F L) - Det Frame (Built 1925);

## Agricultural Buildings

Plot #	Type	Description	Width	Length	Year Built
	Steel Utility Building	2 MACHINE SHED	45	90	1969
	Silo - Enameled Steel	7 HARVESTOR	17	36	1973
	Barn - Feed and Livestock	8 BARN	30	40	1910
	Lean-To	8A LEAN TO	20	30	1910
	Crib	11 GRANARY	8	14	1910
	Bin - Steel Grain Storage	9 ROUND BIN	18	10	1920
	Steel Bulk Feed Tank	10 STORAGE BIN	6	0	1960
	Crib	12 CRIB	26	32	1910
	Confinement - Pre-Cut	6 HOG CONFINEMENT	20	48	1973
	Silage Trench/Bunker	1 BUNKER SILO	32	72	1973
	Bin - Steel Grain Storage	3 DRYING BIN	30	18	1981
	Poultry House	5 CHICKEN HOUSE	10	14	1950
	Bin - Steel Grain Storage	4 DRYING BIN	30	18	1986
	Confinement - Deluxe Open	OPEN FRONT CONF	19	64	1993

**Valuation**

	2021	2020	2019	2018	2017	2016
+ Land	\$52,880	\$55,790	\$55,790	\$80,100	\$80,096	\$95,152
+ Roads	\$0	\$0	\$0	\$0	\$0	\$0
+ Dwelling	\$17,570	\$17,570	\$17,570	\$17,570	\$26,102	\$26,102
+ Building	\$17,630	\$16,690	\$16,690	\$23,140	\$23,164	\$33,359
= Total Assessed Value	<b>\$88,080</b>	<b>\$90,050</b>	<b>\$90,050</b>	<b>\$120,810</b>	<b>\$129,362</b>	<b>\$154,613</b>

**Tax History**

Year	Due Date	Amount	Paid	Date Paid	Receipt
2019	March 2021	\$754	Yes	2021-03-25	4270
	September 2020	\$754	Yes	2020-09-29	
2018	March 2020	\$772	Yes	2020-04-03	4256
	September 2019	\$772	Yes	2019-09-30	
2017	March 2019	\$796	Yes	2019-03-15	4243
	September 2018	\$796	Yes	2018-09-12	
2016	March 2018	\$839	Yes	2018-03-26	4244
	September 2017	\$839	Yes	2017-09-29	
2015	March 2017	\$815	Yes	2017-02-27	3961
	September 2016	\$815	Yes	2016-08-22	
2014	March 2016	\$890	Yes	2016-03-23	4226
	September 2015	\$890	Yes	2015-09-01	

**Photos**



**Sketches**

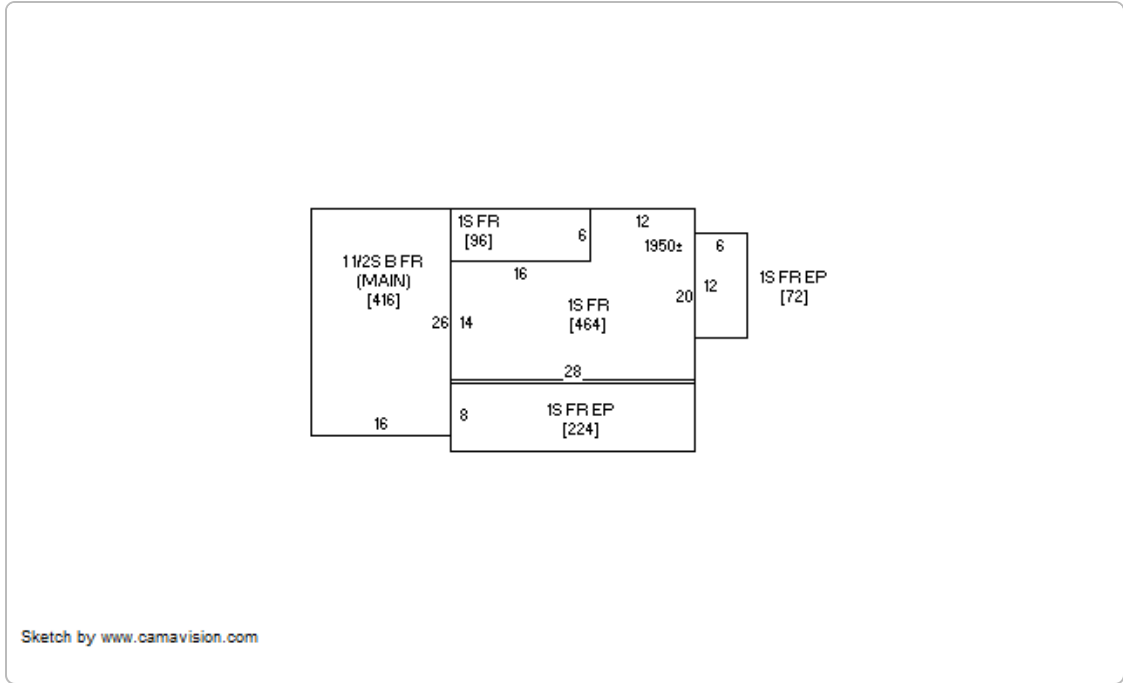

No data available for the following modules: Commercial Buildings, Yard Extras, Sales, Permits, Tax Sale.

IMPORTANT DISCLAIMER: The maps and data available for access at this website are provided 'as is' without warranty or any representation of accuracy, timeliness or completeness. The Schneider Corporation and Cherokee County make no warranties, expressed or implied, as to the use of the maps and data available for access at this website. The user acknowledges and accepts all inherent limitations of the maps and data.

[User Privacy Policy](#)  
[GDPR Privacy Notice](#)

Last Data Upload: [10/12/2021, 8:35:03 PM](#)

Version 2.3.151

