

# Soils Map

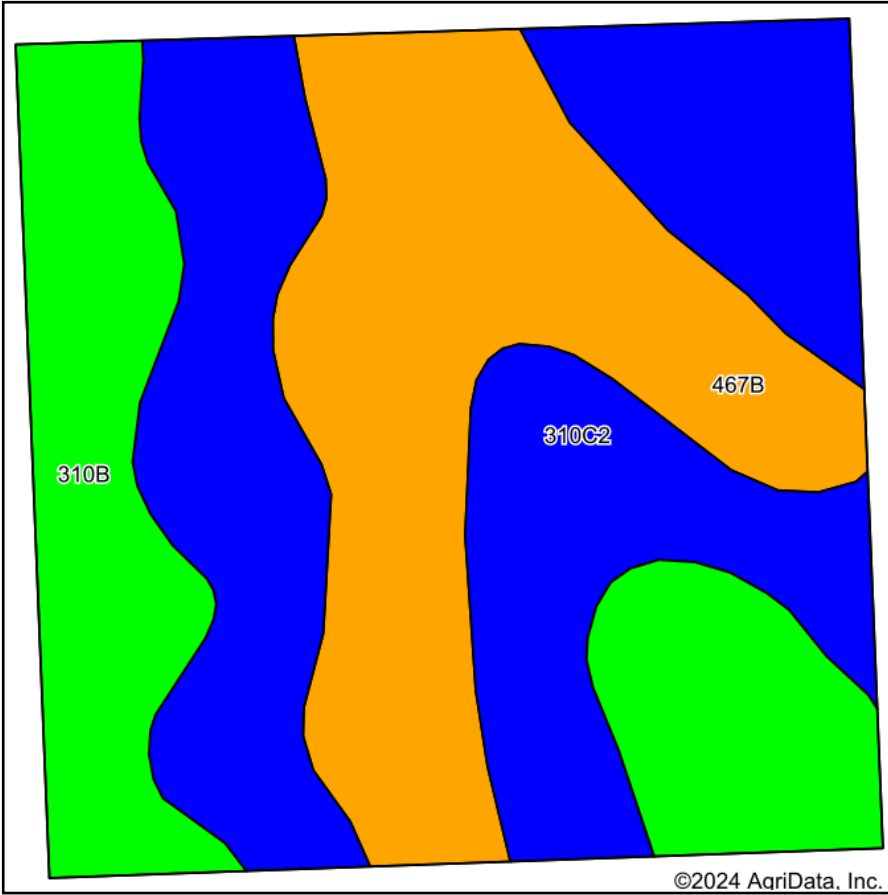

Soils data provided by USDA and NRCS.

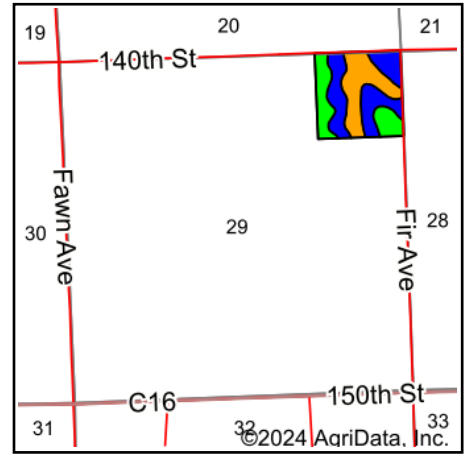

State: **Iowa**  
 County: **Plymouth**  
 Location: **29-93N-47W**  
 Township: **Preston**  
 Acres: **40**  
 Date: **2/14/2024**



Maps Provided By:



Area Symbol: IA149, Soil Area Version: 34

Code	Soil Description	Acres	Percent of field	CSR2 Legend	Non-Irr Class *c	CSR2**	CSR	*n NCCPI Soybeans	
310C2	Galva silty clay loam, 5 to 9 percent slopes, eroded	17.16	42.9%		Ille	84	51	65	
467B	Radford silty clay loam, 2 to 5 percent slopes	12.53	31.3%		Ilw	75	72	77	
310B	Galva silty clay loam, 2 to 5 percent slopes	10.31	25.8%		Ile	95	68	75	
<b>Weighted Average</b>						<b>2.43</b>	<b>84</b>	<b>62</b>	<b>*n 71.3</b>

\*\*IA has updated the CSR values for each county to CSR2.

\*n: The aggregation method is "Weighted Average using all components"

\*\*IA has updated the CSR values for each county to CSR2.\*c: Using Capabilities Class Dominant Condition Aggregation Method