

# Soils Map

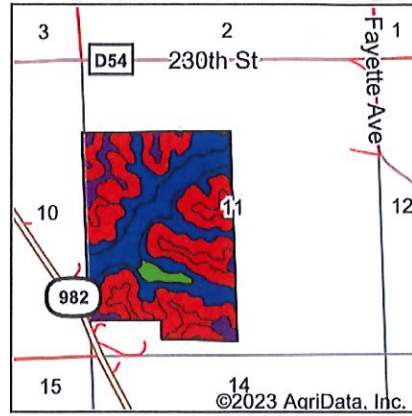

State: **Iowa**  
 County: **Woodbury**  
 Location: **11-87N-46W**  
 Township: **Grange**  
 Acres: **211.13**  
 Date: **4/21/2023**

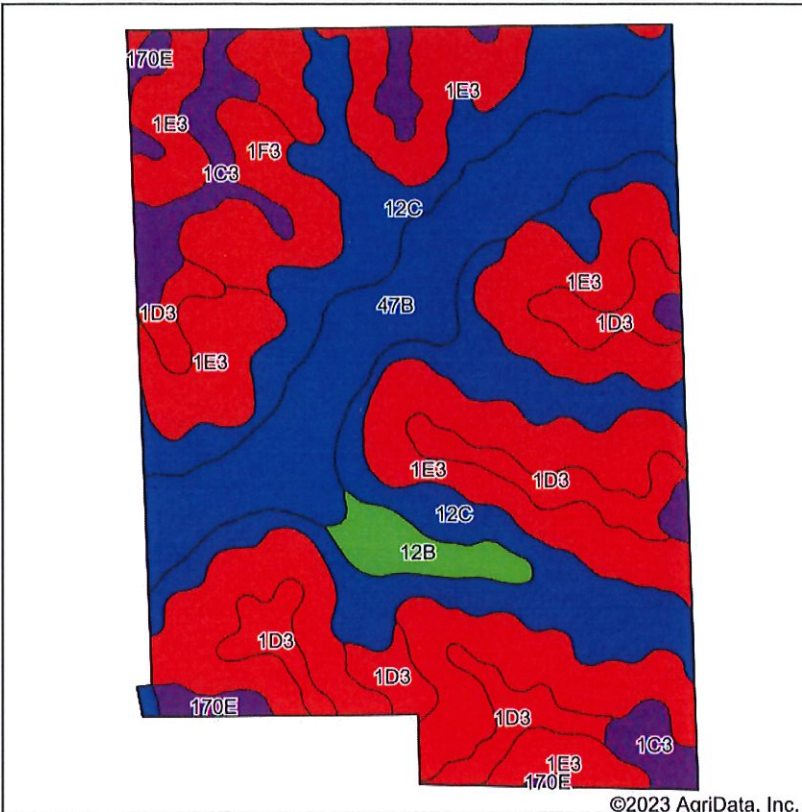

Maps Provided By:



Soils data provided by USDA and NRCS.

©2023 AgriData, Inc.

Area Symbol: IA193, Soil Area Version: 32									
Code	Soil Description	Acres	Percent of field	CSR2 Legend	Non-Irr Class *c	CSR2**	CSR	*n NCCPI Soybeans	
1E3	Ida silt loam, 14 to 20 percent slopes, severely eroded	80.57	38.2%	<span style="color:red">■</span>	IVe	18	28	54	
12C	Napier silt loam, 5 to 9 percent slopes	53.05	25.1%	<span style="color:blue">■</span>	IIIe	89	58	87	
47B	Napier-Rawles complex, 2 to 5 percent slopes	28.59	13.5%	<span style="color:blue">■</span>	IIw	85	59	74	
1D3	Ida silt loam, 9 to 14 percent slopes, severely eroded	20.09	9.5%	<span style="color:red">■</span>	IIIe	32	37	59	
1C3	Ida silt loam, 5 to 9 percent slopes, severely eroded	12.25	5.8%	<span style="color:purple">■</span>	IIIe	58	46	61	
1F3	Ida silt loam, 20 to 30 percent slopes, severely eroded	8.91	4.2%	<span style="color:red">■</span>	VIe	8	9	10	
12B	Napier silt loam, 2 to 5 percent slopes	4.75	2.2%	<span style="color:green">■</span>	Ile	93	72	90	
170E	Napier-Castana silt loams, 9 to 20 percent slopes	2.92	1.4%	<span style="color:purple">■</span>	IIIe	56	34	76	
<b>Weighted Average</b>						<b>3.35</b>	<b>50.4</b>	<b>41.9</b>	<b>*n 65.1</b>

\*\*IA has updated the CSR values for each county to CSR2.  
 \*n: The aggregation method is "Weighted Average using all components"  
 \*c: Using Capabilities Class Dominant Condition Aggregation Method