

Soils Map

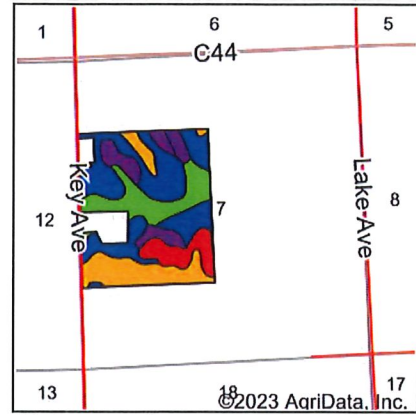

State: Iowa
 County: Plymouth
 Location: 7-91N-45W
 Township: Stanton
 Acres: 126
 Date: 1/17/2023

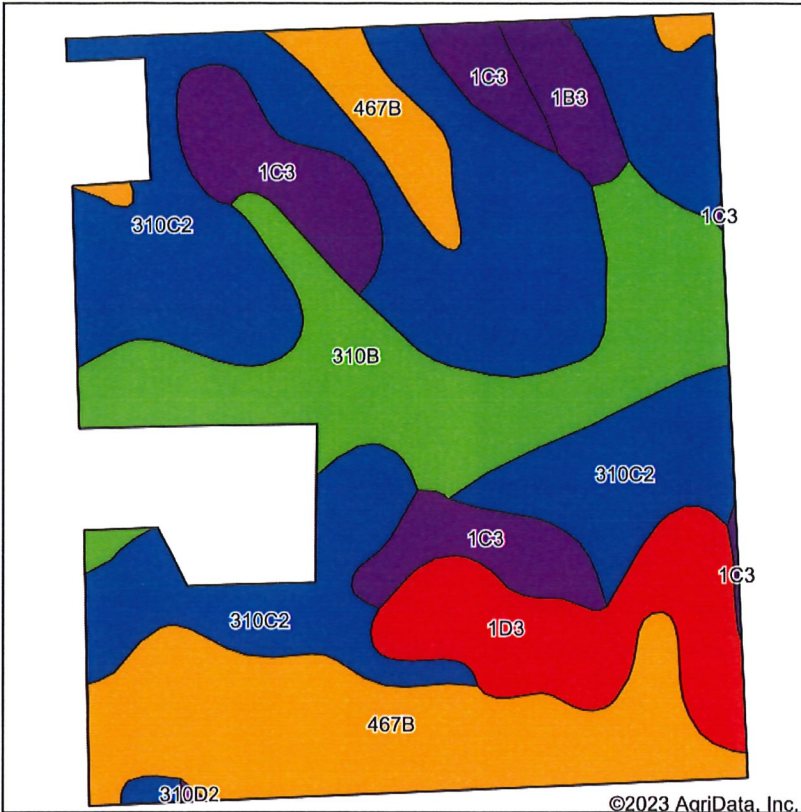

Maps Provided By:



Soils data provided by USDA and NRCS.

©2023 AgriData, Inc.

Area Symbol: IA149, Soil Area Version: 33									
Code	Soil Description	Acres	Percent of field	CSR2 Legend	Non-Irr Class *c	CSR2**	CSR	*n NCCPI Soybeans	
310C2	Galva silty clay loam, 5 to 9 percent slopes, eroded	50.87	40.4%		IIIe	84	51	65	
467B	Radford silty clay loam, 2 to 5 percent slopes	25.47	20.2%		IIw	75	72	77	
310B	Galva silty clay loam, 2 to 5 percent slopes	22.23	17.6%		Ile	95	68	75	
1C3	Ida silt loam, 5 to 9 percent slopes, severely eroded	12.44	9.9%		IIIe	58	44	61	
1D3	Ida silt loam, 9 to 14 percent slopes, severely eroded	11.88	9.4%		IIIe	32	35	59	
1B3	Ida silt loam, 2 to 5 percent slopes, severely eroded	3.03	2.4%		Ile	57	57	59	
310D2	Galva silty clay loam, 9 to 14 percent slopes, eroded	0.08	0.1%		IIIe	57	42	60	
Weighted Average						2.60	76	56.2	*n 68.1

**IA has updated the CSR values for each county to CSR2.

*n: The aggregation method is "Weighted Average using all components"

*c: Using Capabilities Class Dominant Condition Aggregation Method

Soils data provided by USDA and NRCS.