

Soils Map

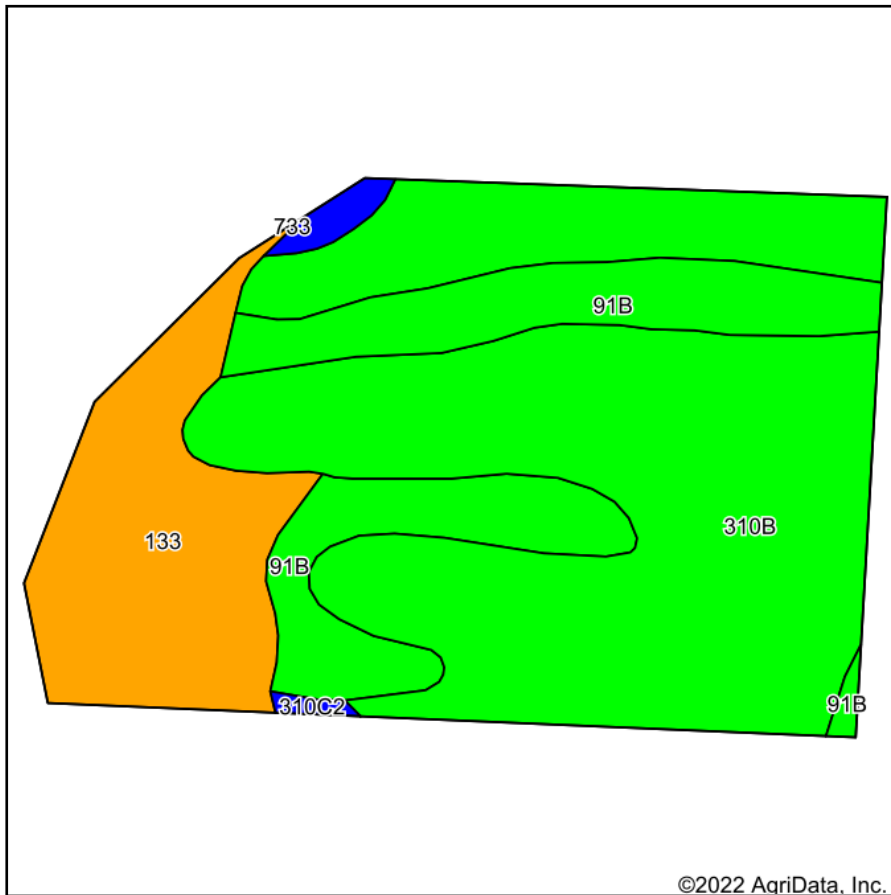

Soils data provided by USDA and NRCS.

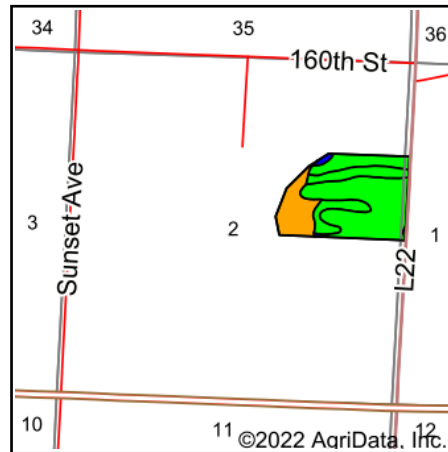

State: **Iowa**
 County: **Plymouth**
 Location: **2-92N-43W**
 Township: **Remsen**
 Acres: **55.56**
 Date: **8/30/2022**



Maps Provided By:



© AgriData, Inc. 2021

www.AgriDataInc.com



Area Symbol: IA149, Soil Area Version: 32

Code	Soil Description	Acres	Percent of field	CSR2 Legend	Non-Irr Class *c	CSR2**	CSR	*n NCCPI Soybeans	
310B	Galva silty clay loam, 2 to 5 percent slopes	33.90	61.0%		Ile	95	68	76	
91B	Primghar silty clay loam, 2 to 5 percent slopes	10.75	19.3%		Ile	95	76	78	
133	Colo silty clay loam, deep loess, 0 to 2 percent slopes, occasionally flooded	10.18	18.3%		Ilw	78	71	80	
310C2	Galva silty clay loam, 5 to 9 percent slopes, eroded	0.73	1.3%		Ille	84	51	66	
Weighted Average						2.01	91.7	69.9	*n 77

**IA has updated the CSR values for each county to CSR2.

*n: The aggregation method is "Weighted Average using all components"

*c: Using Capabilities Class Dominant Condition Aggregation Method

Soils data provided by USDA and NRCS.