

# Soils Map

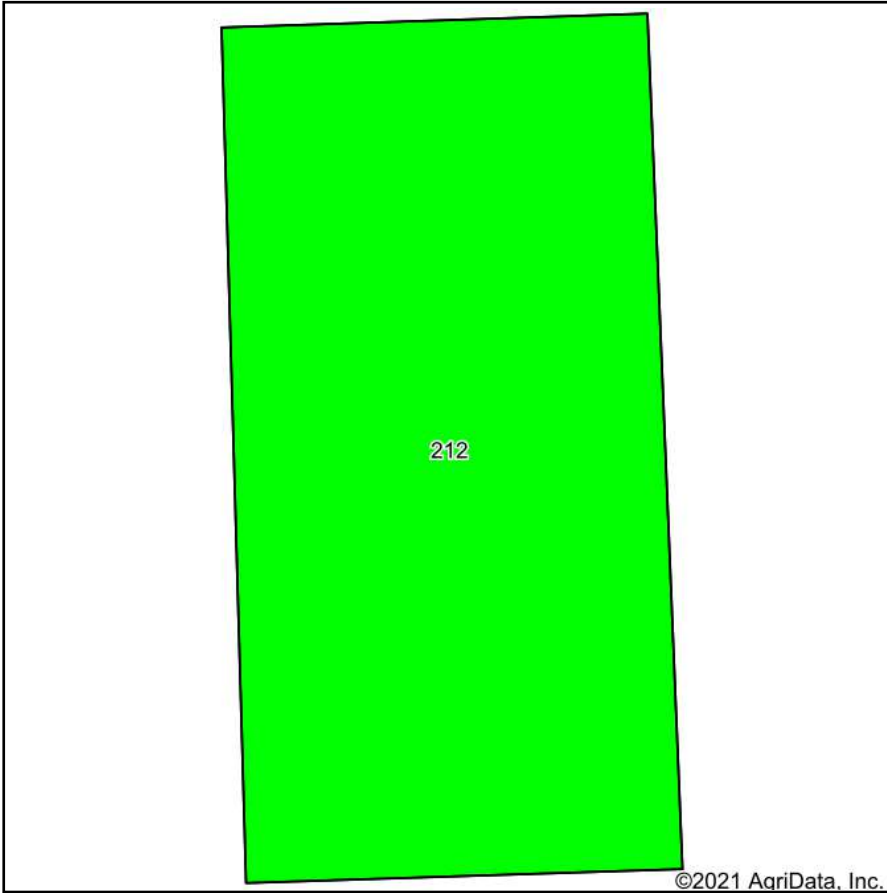

Soils data provided by USDA and NRCS.

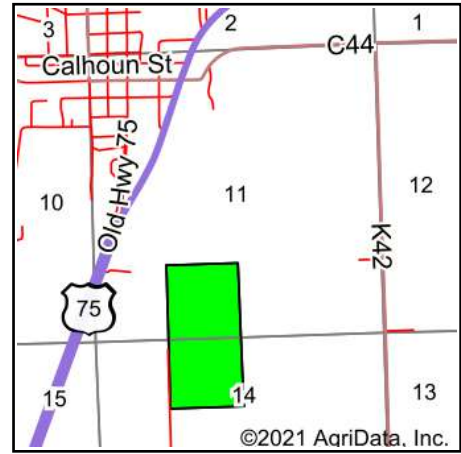

State: **Iowa**  
 County: **Plymouth**  
 Location: **11-91N-46W**  
 Township: **Plymouth**  
 Acres: **80**  
 Date: **10/28/2021**



Maps Provided By



© AgriData, Inc. 2021

www.AgriDataInc.com



Area Symbol: IA149, Soil Area Version: 31

Code	Soil Description	Acres	Percent of field	CSR2 Legend	Non-Irr Class *c	CSR2**	CSR	*n NCCPI Soybeans
212	Kennebec silt loam, 0 to 2 percent slopes, occasionally flooded	80.00	100.0%		lw	91	80	93
<b>Weighted Average</b>						<b>1.00</b>	<b>91</b>	<b>80</b>
								<b>*n 93</b>

\*\*IA has updated the CSR values for each county to CSR2.

\*n: The aggregation method is "Weighted Average using all components"

\*c: Using Capabilities Class Dominant Condition Aggregation Method

Soils data provided by USDA and NRCS.