

Soils Map

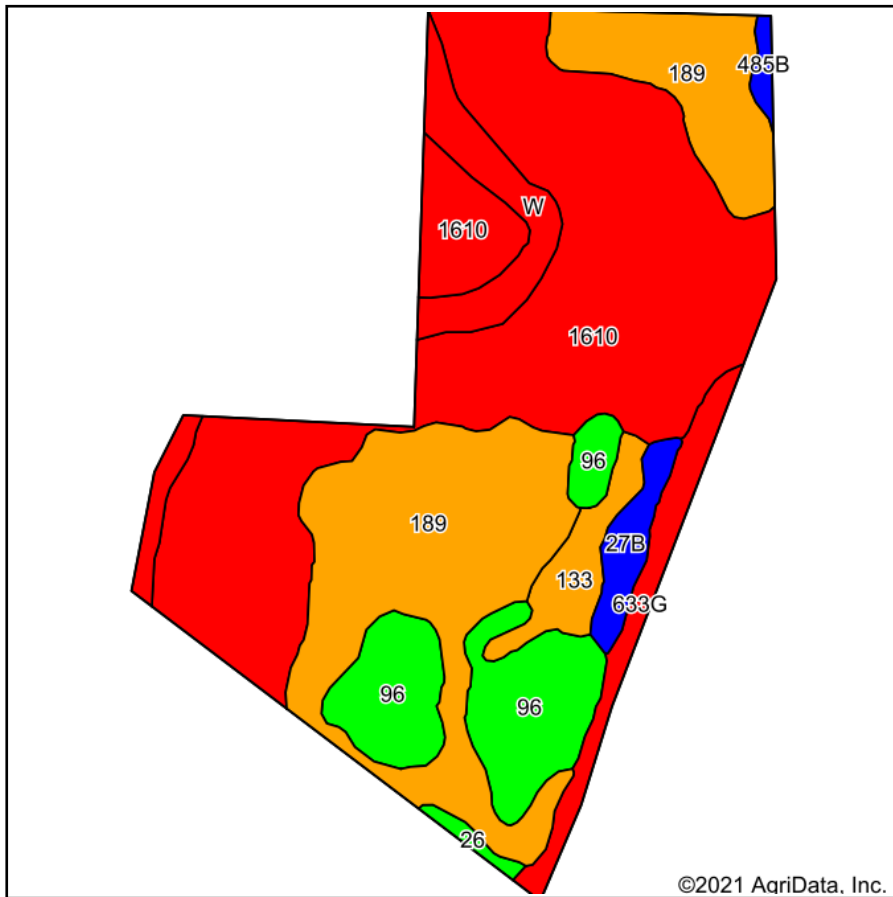

Soils data provided by USDA and NRCS.

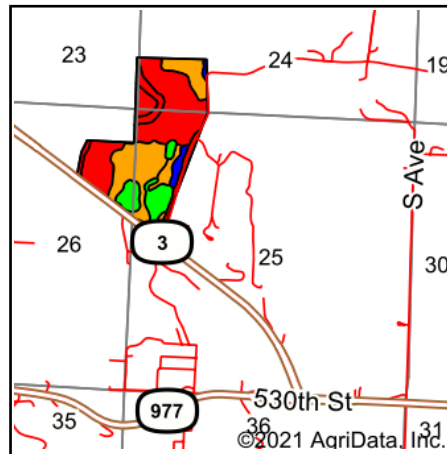

State: **Iowa**
 County: **Cherokee**
 Location: **25-92N-40W**
 Township: **Cherokee**
 Acres: **105**
 Date: **10/13/2021**



Maps Provided By:



© AgriData, Inc. 2021

www.AgriDataInc.com



Area Symbol: IA035, Soil Area Version: 30

Code	Soil Description	Acres	Percent of field	CSR2 Legend	Non-Irr Class *c	Irr Class *c	CSR2**	CSR	*n NCCPI Soybeans	
1610	Fluvaquents-Omadi complex, 0 to 2 percent slopes, occasionally flooded	46.39	44.2%	[Red]		IIw	38		83	
189	Omadi silty clay loam, 0 to 2 percent slopes	29.24	27.8%	[Orange]		Iw	79	68	80	
96	Turlin loam, 0 to 2 percent slopes	12.40	11.8%	[Green]		IIw	94	71	84	
W	Water	6.02	5.7%	[Red]			0	0		
633G	Steinauer-Steinauer variant clay loams, 20 to 50 percent slopes	4.16	4.0%	[Red]		VIIe	5	5	7	
133	Colo silty clay loam, deep loess, 0 to 2 percent slopes, occasionally flooded	3.35	3.2%	[Orange]		IIw	78	74	80	
27B	Terril loam, 2 to 5 percent slopes	2.31	2.2%	[Blue]		Ile	90	68	83	
485B	Spillville loam, 1 to 4 percent slopes	0.57	0.5%	[Blue]		Ile	89	71	80	
26	Kennebec silty clay loam, 0 to 2 percent slopes, occasionally flooded	0.56	0.5%	[Green]		Iw	92	80	79	
Weighted Average							1.80	0.28	55.5	*n 74.4

**IA has updated the CSR values for each county to CSR2.

*- CSR weighted average cannot be calculated on the current soils data, use prior data version for csr values.

*n: The aggregation method is "Weighted Average using all components"

*c: Using Capabilities Class Dominant Condition Aggregation Method

Soils data provided by USDA and NRCS.