

Soils Map

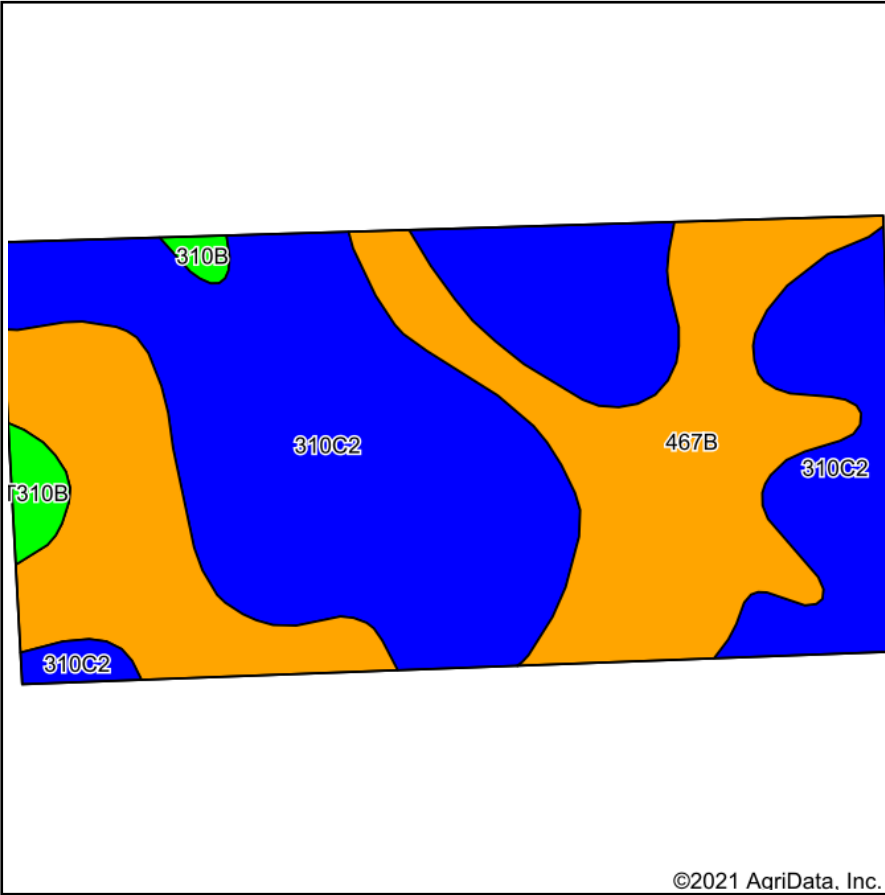

Soils data provided by USDA and NRCS.

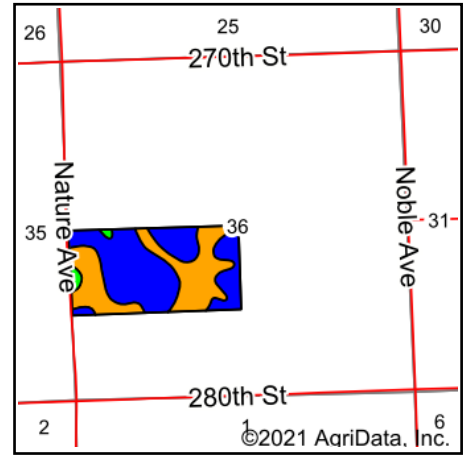

State: **Iowa**
 County: **Plymouth**
 Location: **36-91N-45W**
 Township: **Stanton**
 Acres: **80**
 Date: **9/8/2021**



Maps Provided By:



Area Symbol: IA149, Soil Area Version: 31

Code	Soil Description	Acres	Percent of field	CSR2 Legend	Non-Irr Class *c	CSR2**	CSR	*n NCCPI Soybeans
310C2	Galva silty clay loam, 5 to 9 percent slopes, eroded	46.29	57.9%		IIIe	84	51	66
467B	Radford silty clay loam, 2 to 5 percent slopes	32.06	40.1%		Ile	75	72	82
T310B	Galva silty clay loam, terrace, 2 to 5 percent slopes	1.19	1.5%		Ile	95	69	76
310B	Galva silty clay loam, 2 to 5 percent slopes	0.46	0.6%		Ile	95	68	76
Weighted Average						80.6	59.8	*n 72.6

**IA has updated the CSR values for each county to CSR2.

*n: The aggregation method is "Weighted Average using all components"

*c: Using Capabilities Class Dominant Condition Aggregation Method

Soils data provided by USDA and NRCS.