

# Soils Map

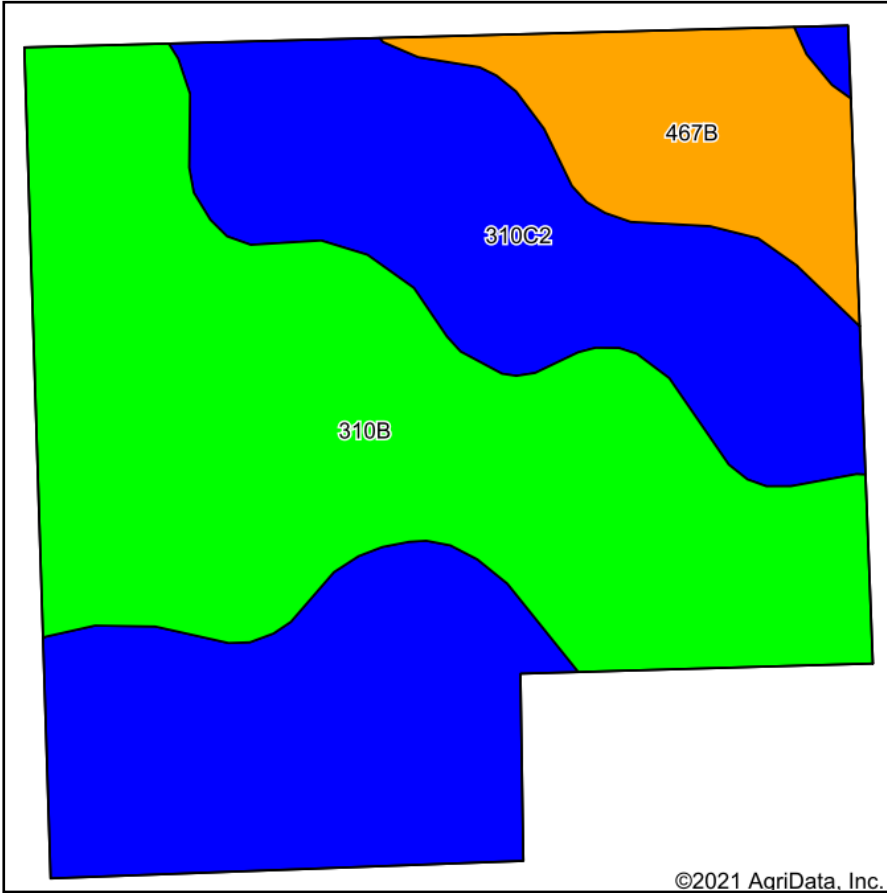

Soils data provided by USDA and NRCS.

©2021 AgriData, Inc.

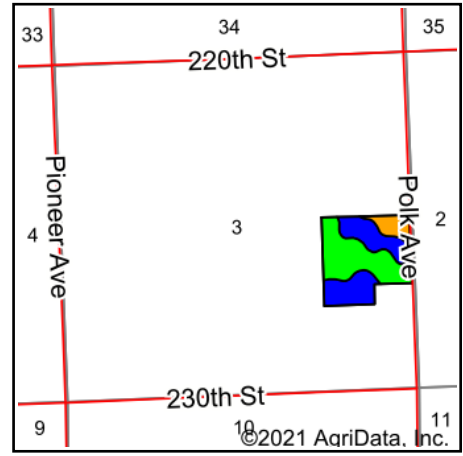

State: **Iowa**  
 County: **Plymouth**  
 Location: **3-91N-44W**  
 Township: **Union**  
 Acres: **36.5**  
 Date: **8/18/2021**



Maps Provided By:



© AgriData, Inc. 2021

www.AgriDataInc.com



Area Symbol: IA149, Soil Area Version: 31

Code	Soil Description	Acres	Percent of field	CSR2 Legend	Non-Irr Class *c	CSR2**	CSR	*n NCCPI Soybeans
310B	Galva silty clay loam, 2 to 5 percent slopes	16.42	45.0%		Ile	95	68	76
310C2	Galva silty clay loam, 5 to 9 percent slopes, eroded	16.17	44.3%		IIle	84	51	66
467B	Radford silty clay loam, 2 to 5 percent slopes	3.91	10.7%		Ile	75	72	82
<b>Weighted Average</b>						<b>88</b>	<b>60.9</b>	<b>*n 72.2</b>

\*\*IA has updated the CSR values for each county to CSR2.

\*n: The aggregation method is "Weighted Average using all components"

\*c: Using Capabilities Class Dominant Condition Aggregation Method

Soils data provided by USDA and NRCS.