

# Soils Map

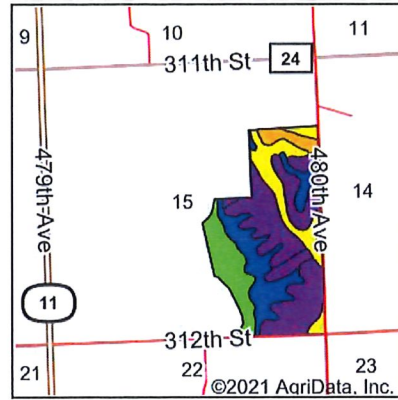

State: **South Dakota**  
 County: **Union**  
 Location: **15-93N-49W**  
 Township: **Sioux Valley**  
 Acres: **158.41**  
 Date: **8/26/2021**

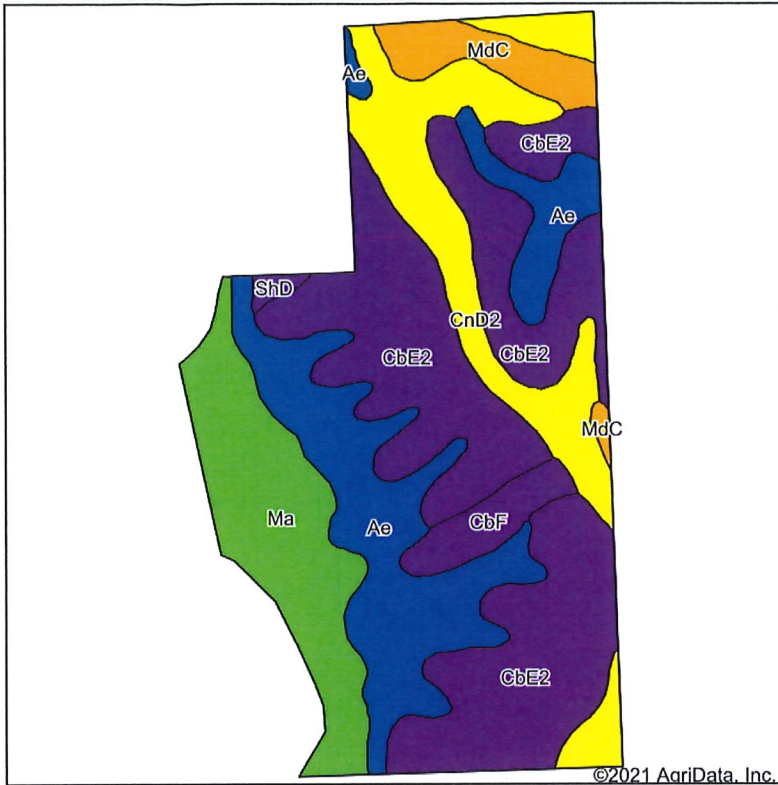

Maps Provided By:



© AgriData, Inc. 2021

www.AgriDataInc.com



Soils data provided by USDA and NRCS.

Area Symbol: SD127, Soil Area Version: 24

Code	Soil Description	Acres	Percent of field	Non-Irr Class Legend	Non-Irr Class *c	Irr Class *c	Productivity Index	Alfalfa hay	Bromegrass alfalfa	Corn	Corn Irrigated	Grain sorghum	Oats	Soybeans	Soybeans Irrigated	*n NCCPI Soybeans
CbE2	Crofton silt loam, 12 to 20 percent slopes, eroded	63.38	40.0%		Vle		41									63
Ae	Alcester silty clay loam, 2 to 6 percent slopes	34.04	21.5%		Ile	IIIe	90									72
CnD2	Crofton-Nora complex, 6 to 11 percent slopes, eroded	25.07	15.8%		IVe	IVe	47									66
Ma	McPaul silt loam	23.24	14.7%		Iw		90			5	90	140	70	34	44	74
MdC	Moody-Nora silty clay loams, 6 to 10 percent slopes	6.86	4.3%		IIIe	IVe	70	3.6		6	71	120	66	67	24	64
CbF	Crofton silt loam, 17 to 30 percent slopes, eroded	5.03	3.2%		Vle		0									37

Soils data provided by USDA and NRCS.

Maps Provided By:



© AgriData, Inc. 2021 www.AgriDataInc.com

Code	Soil Description	Acres	Percent of field	Non-Irr Class Legend	Non-Irr Class *c	Irr Class *c	Productivity Index	Alfalfa hay	Bromegrass alfalfa	Corn	Corn Irrigated	Grain sorghum	Oats	Soybeans	Soybeans Irrigated	*n NCCPI Soybeans
ShD	Shindler clay loam, 9 to 15 percent slopes	0.79	0.5%		Vle		36									56
<b>Weighted Average</b>							<b>59.6</b>	<b>0.2</b>	<b>1</b>	<b>16.3</b>	<b>25.7</b>	<b>2.9</b>	<b>13.2</b>	<b>6</b>	<b>6.5</b>	<b>*n 66.2</b>

\*n: The aggregation method is "Weighted Average using all components"

\*c: Using Capabilities Class Dominant Condition Aggregation Method