

# Soils Map

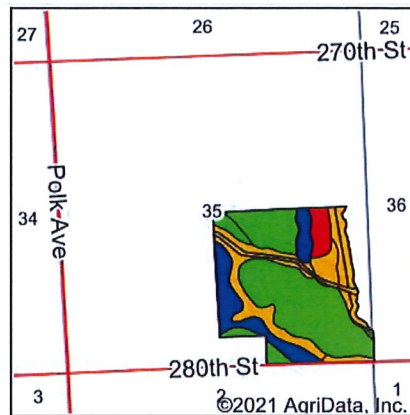

State: **Iowa**  
 County: **Plymouth**  
 Location: **35-91N-44W**  
 Township: **Union**  
 Acres: **134.06**  
 Date: **5/17/2021**

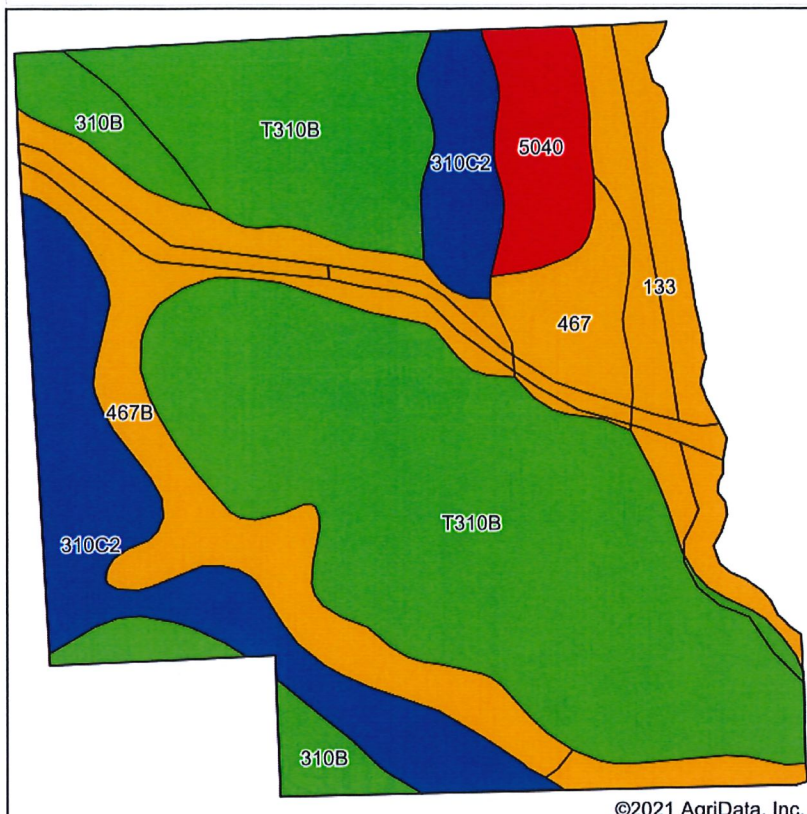

Maps Provided By:



Soils data provided by USDA and NRCS.

©2021 AgriData, Inc.

© AgriData, Inc. 2021

www.AgriDataInc.com

Area Symbol: IA149, Soil Area Version: 31								
Code	Soil Description	Acres	Percent of field	CSR2 Legend	Non-Irr Class *c	CSR2**	CSR	*n NCCPI Soybeans
T310B	Galva silty clay loam, terrace, 2 to 5 percent slopes	60.83	45.4%		Ile	95	69	76
310C2	Galva silty clay loam, 5 to 9 percent slopes, eroded	21.12	15.8%		IIIle	84	51	66
467B	Radford silty clay loam, 2 to 5 percent slopes	20.64	15.4%		Ile	75	72	82
133	Colo silty clay loam, deep loess, 0 to 2 percent slopes, occasionally flooded	12.85	9.6%		IIw	78	71	80
310B	Galva silty clay loam, 2 to 5 percent slopes	7.00	5.2%		Ile	95	68	76
5040	Udorthents, loamy	5.97	4.5%			5	5	
467	Radford silty clay loam, 0 to 2 percent slopes	5.65	4.2%		Iw	79	74	84
<b>Weighted Average</b>						<b>83.9</b>	<b>64.1</b>	<b>*n 72.7</b>

\*\*IA has updated the CSR values for each county to CSR2.

\*n: The aggregation method is "Weighted Average using all components"

\*c: Using Capabilities Class Dominant Condition Aggregation Method

Soils data provided by USDA and NRCS.