

# Soils Map

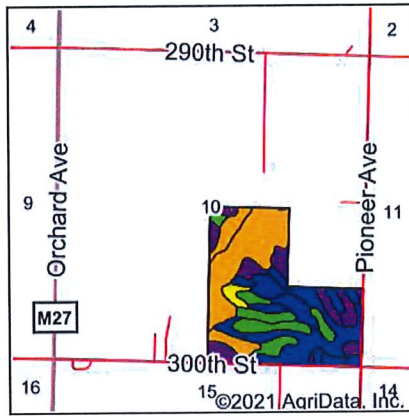

State: **Iowa**  
 County: **Ida**  
 Location: **10-86N-39W**  
 Township: **Hayes**  
 Acres: **120**  
 Date: **5/19/2021**

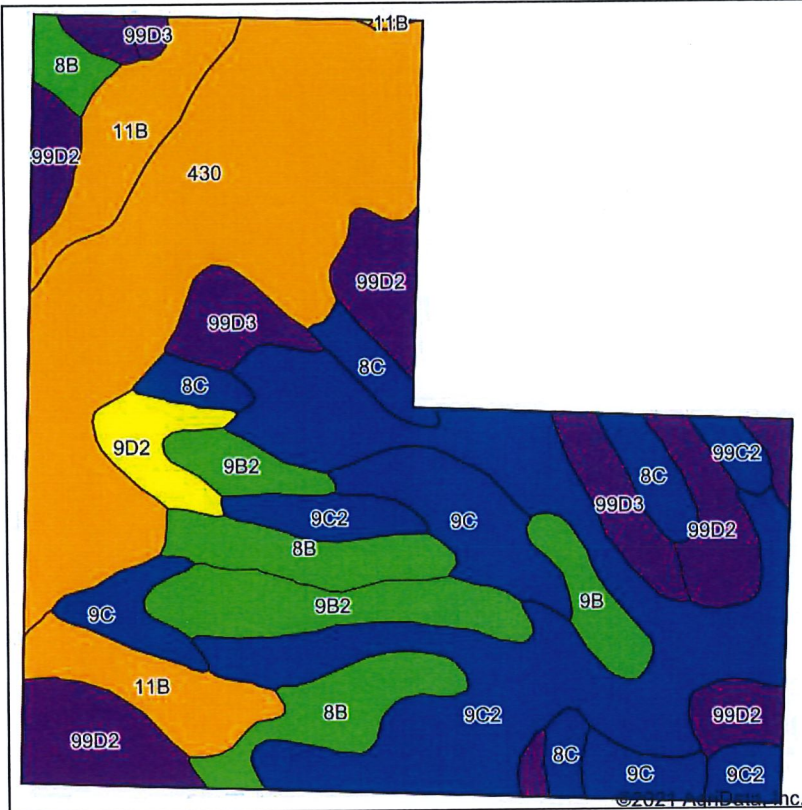

Maps Provided By:



Soils data provided by USDA and NRCS.

Area Symbol: IA093, Soil Area Version: 31								
Code	Soil Description	Acres	Percent of field	CSR2 Legend	Non-Irr Class *c	CSR2**	CSR	*n NCCPI Soybeans
9C2	Marshall silty clay loam, 5 to 9 percent slopes, eroded	28.18	23.5%		IIIe	87	62	71
430	Ackmore silt loam, 0 to 2 percent slopes, occasionally flooded	28.05	23.4%		IIw	77	79	86
99D2	Exira silty clay loam, 9 to 14 percent slopes, eroded	14.36	12.0%		IIIe	59	50	66
11B	Colo-Judson silty clay loams, 0 to 5 percent slopes, occasionally flooded	9.19	7.7%		IIw	80	62	81
8B	Judson silty clay loam, deep loess, 2 to 5 percent slopes	8.77	7.3%		Ile	92	76	81
9C	Marshall silty clay loam, 5 to 9 percent slopes	8.29	6.9%		IIIe	89	64	81
9B2	Marshall silty clay loam, 2 to 5 percent slopes, eroded	7.10	5.9%		Ile	92	76	72
99D3	Exira silty clay loam, 9 to 14 percent slopes, severely eroded	5.29	4.4%		IVe	52	47	55
8C	Judson silty clay loam, deep loess, 5 to 9 percent slopes	5.17	4.3%		IIIe	87	61	78
9D2	Marshall silty clay loam, 9 to 14 percent slopes, eroded	2.52	2.1%		IIIe	61	53	66
9B	Marshall silty clay loam, 2 to 5 percent slopes	2.10	1.8%		Ile	95	77	77
99C2	Exira silty clay loam, 5 to 9 percent slopes, eroded	0.98	0.8%		IIIe	87	59	70
<b>Weighted Average</b>						<b>79.6</b>	<b>65.9</b>	<b>*n 75.7</b>

\*\*IA has updated the CSR values for each county to CSR2.  
 \*n: The aggregation method is "Weighted Average using all components"  
 \*c: Using Capabilities Class Dominant Condition Aggregation Method

Soils data provided by USDA and NRCS.