

# Soils Map

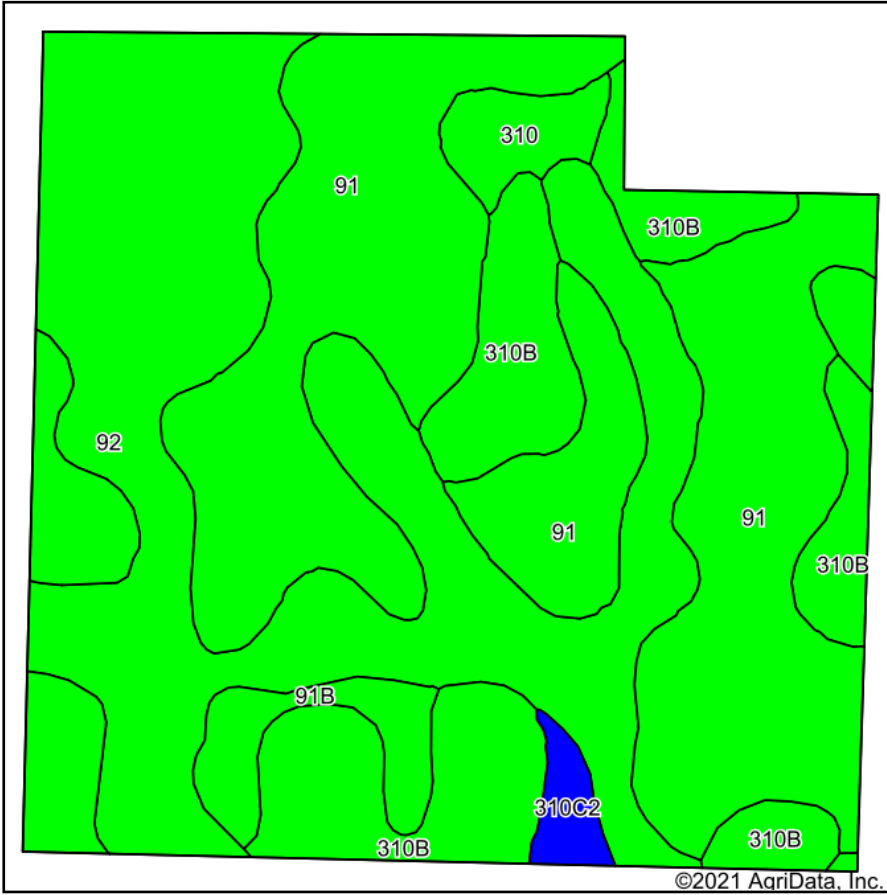

Soils data provided by USDA and NRCS.

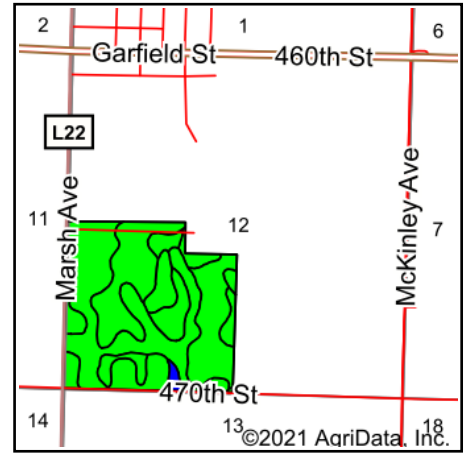

State: **Iowa**  
 County: **Sioux**  
 Location: **12-94N-43W**  
 Township: **East Orange**  
 Acres: **151**  
 Date: **3/11/2021**



Maps Provided By:



Area Symbol: IA167, Soil Area Version: 30

Code	Soil Description	Acres	Percent of field	CSR2 Legend	Non-Irr Class *c	CSR2**	CSR	*n NCCPI Soybeans
91	Primghar silty clay loam, 0 to 2 percent slopes	64.54	42.7%		Iw	100	77	78
92	Marcus silty clay loam, 0 to 2 percent slopes	54.25	35.9%		IIw	94	72	75
310B	Galva silty clay loam, 2 to 5 percent slopes	23.08	15.3%		Ile	95	67	76
91B	Primghar silty clay loam, 2 to 5 percent slopes	4.29	2.8%		Ile	95	75	78
310	Galva silty clay loam, 0 to 2 percent slopes	3.14	2.1%		I	100	72	77
310C2	Galva silty clay loam, 5 to 9 percent slopes, eroded	1.70	1.1%		IIIe	84	51	66
<b>Weighted Average</b>						<b>96.8</b>	<b>73.2</b>	<b>*n 76.5</b>

\*\*IA has updated the CSR values for each county to CSR2.

\*n: The aggregation method is "Weighted Average using all components"

\*c: Using Capabilities Class Dominant Condition Aggregation Method

Soils data provided by USDA and NRCS.