

TILDEN

TOWNSHIP 91 NORTH - RANGE 42 WEST OF 5TH PM.

1. Sec.4 Byron Miller, etux-0.76
2. Sec.34 Douglas Rutter, etux-11.04
3. Sec.10 Renea Ogren-0.88
4. Sec.30 Lloyd Mattoon, etux-11.28
5. Sec.27 Thomas Harmon-0.95
6. Sec.27 First Coop Ass'n-0.28
7. Sec.24 Douglas Kohn, etux-6.76
8. Sec.15 Ronald Margon, etux-8.91
9. Sec.25 Northwest Iowa Power Coop-1.52
10. Sec.25 Northwest Iowa Power Coop-0.55
11. Sec.25 Robert Blair, etux-5.7
12. Sec.25 Robert Blair, etux-2.65
13. Sec.25 Duthie Family Farms LLC-20
14. Sec.14 Cherokee Co. Rural Water
15. Sec.28 Robert Boothby, etux-1.05
16. Sec.5 Alma Harnack (LE)-20
17. Sec.8 Peters Lauters, etux-10
18. Sec.9 Letsche & Sons, Inc.-10.03
19. Sec.2 Charles Ogren, etux-1.72
20. Sec.16 Tilden Twp. Hall-1
21. Sec.22 Jerry Johnson, etux-1.17
22. Sec.30 William Hissem, etal-5
23. Sec.34 Gary Zubrod, etux-4.24
24. Sec.29 Lloyd Mattoon, etux-2.5
25. Sec.1 Thomas Lennhoff, etux-13.44
26. Sec.12 Nicholas Rose, etux-4.89
27. Sec.20 Eleanor Sokolowski-6.15
28. Sec.22 Anthony Cronin, etux-4.72
29. Sec.28 Dean Berger-0.67
30. Sec.17 Keith Grage, etux-7.44
31. Sec.32 George Bailey, etux-9.52
32. Sec.27 Thomas Harmon, etux-0.3
33. Sec.2 Chad Florine, etux-10
34. Sec.5 Leland Mohning, etux-10
35. Sec.5 Maureen Glassmaker-40
36. Sec.11 Neal Rupp, etux-2.23
37. Sec.14 John Weber, etux-11
38. Sec.14 John Weber, etux-4.72
39. Sec.16 Wade Berger, etux-6.78
40. Sec.35 Cameron Crocker-6.26
41. Sec.19 Ronald Pottebaum, etux-4.2
42. Sec.1 Tom Lehnhoff-40
43. Sec.2 Magnolia Farms LLC-3.64
44. Sec.4 Michael Becker, etux-4.02
45. Sec.7 Clarence Pearson Jr. (LE)-8.66
46. Sec.7 Kirk Letsche, etux-8.05
47. Sec.8 John Galles-4.2
48. Sec.10 Randall Bush-21.01
49. Sec.11 Magnolia Farms LLC-3.19
50. Sec.11 Kyle Schmillen-4.77
51. Sec.12 Nicholas Kirchner, etux-3.15
52. Sec.15 Edward Schlenger, etux-2.43
53. Sec.17 Jed Henrich, etux-7.54
54. Sec.18 C & O II Inc.-4.62
55. Sec.21 James Dixson-7.46
56. Sec.23 Tamara Johnson-8.16
57. Sec.23 Skybox Farms LLC-2.77
58. Sec.25 Allan Sears, etux-4.57
59. Sec.27 Dennis Hohbach-19.01

AMHERST

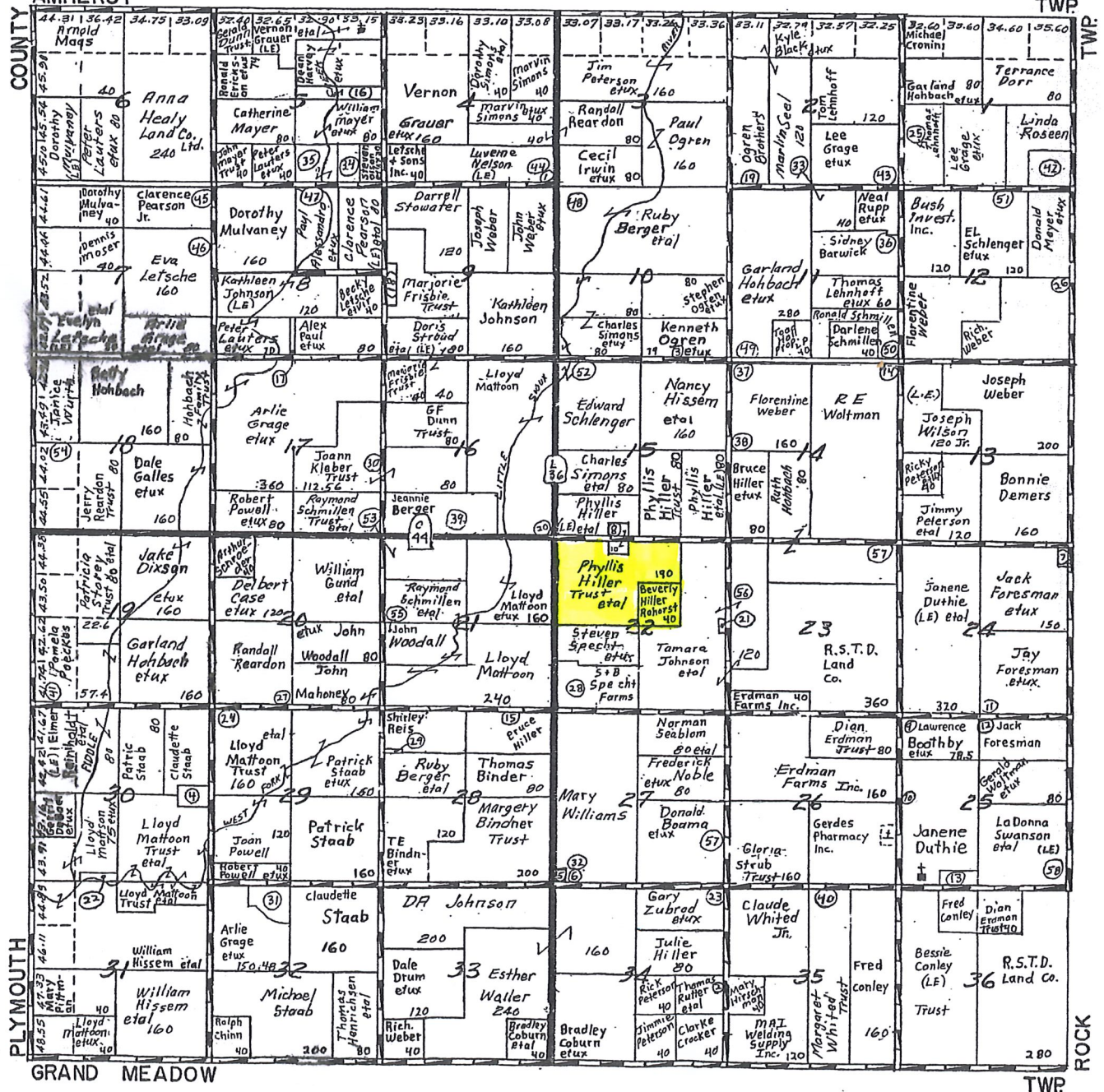

GRAND MEADOW

TWP