

Soils Map

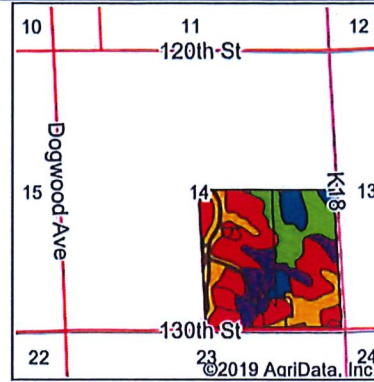

State: Iowa
 County: Plymouth
 Location: 14-93N-48W
 Township: Portland
 Acres: 151.03
 Date: 6/13/2019

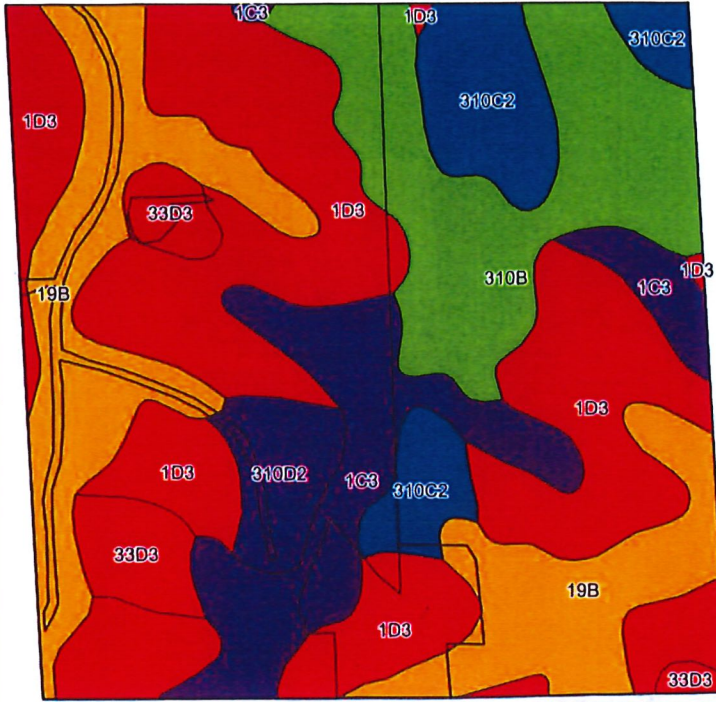

Soils data provided by USDA and NRCS.

Area Symbol: IA149, Soil Area Version: 29

Code	Soil Description	Acres	Percent of field	CSR2 Legend	Non-Irr Class *c	CSR2**	CSR	*n NCCPI Soybeans
1D3	Ida silt loam, 9 to 14 percent slopes, severely eroded	54.96	36.4%	■	IIIe	32	35	47
19B	Kennebec-McPaul silt loams, 2 to 5 percent slopes	30.32	20.1%	■	Ile	79	73	75
310B	Galva silty clay loam, 2 to 5 percent slopes	23.47	15.5%	■	Ile	95	68	74
1C3	Ida silt loam, 5 to 9 percent slopes, severely eroded	18.29	12.1%	■	IIIe	58	44	49
310C2	Galva silty clay loam, 5 to 9 percent slopes, eroded	12.39	8.2%	■	IIIe	84	51	61
33D3	Steinauer clay loam, 9 to 14 percent slopes, severely eroded	6.52	4.3%	■	IVe	22	44	36
310D2	Galva silty clay loam, 9 to 14 percent slopes, eroded	5.08	3.4%	■	IIIe	57	42	56
Weighted Average						59	50.8	*n 58

**IA has updated the CSR values for each county to CSR2.
 *n: The aggregation method is "Weighted Average using major components"
 *c: Using Capabilities Class Dominant Condition Aggregation Method

Soils data provided by USDA and NRCS.