

Beacon™ Woodbury County, IA / Sioux City

Summary

Parcel ID 894716361023
 Alternate ID 562473
 Property 2800 SUMMIT ST
 Address SIOUX CITY
 Sec/Twp/Rng N/A
 Brief PEIRCES ADDITION LOT 11 & S 14 LOT 12; E 10 FT SUMMIT
 Tax Description ST ADJ; PT VAC N/S ALLEY ADJ TO LOT 11 S 14 FT LOT 12
 ALL IN BLK 14; AND AN IRREG TCT IN NW NW OF 21-89-47
 BEG AT SW COR OF LOT 11 BLK 14 PEIRCES ADDN THNC E
 149.70 FT, THNC E 16 FT, THNC S 40 FT, THN
 (Note: Not to be used on legal documents)
 Deed 2020-07329 (6/19/2020)
 Book/Page
 Gross Acres 0.00
 Net Acres 0.00
 Adjusted CSR 0
 Pts
 Class R - Residential
 (Note: This is for tax purposes only. Not to be used for zoning.)
 District N/A
 School District SIOUX CITY COMM
 Neighborhood Valley Drive
 Main Area 1129
 Square Feet



Owner

Deed Holder
 Posey Lynn L
 % Turner Marilyn E
 2601 S Lemon St
 Sioux City IA 51106

Contract Holder

Mailing Address

Land

Lot Area 0.37 Acres ; 16,013 SF

Residential Dwellings

Residential Dwelling
 Occupancy Single-Family / Owner Occupied
 Style 1 Story Brick
 Architectural Style Raised Ranch/Tuck Under
 Year Built 1933
 Condition Normal
 Roof Asph / Gable
 Flooring Carp / Hdwd
 Foundation C Blk
 Exterior Material Brk
 Interior Material Plas / Drwl
 Brick or Stone Veneer 1 Story Brick; 16 linear ft.
 Total Gross Living Area 2,457 SF
 Attic Type 3/4 Finished; 508 SF
 Number of Rooms 6 above; 0 below
 Number of Bedrooms 2 above; 0 below
 Basement Area Type Full
 Basement Area 1,539
 Basement Finished Area
 Plumbing 1 Base Plumbing (Full ; 1 Three Quarter Bath; 1 Water Closet; 1 Sink;
 Appliances 1 Dishwasher;
 Central Air Yes
 Heat Yes
 Fireplaces 1 Masonry; 1 Prefab;
 Porches 1S Frame Open (77 SF); Frame 3 Seasons (196 SF); Concrete Stoop/Deck (160 SF);
 Decks Wood Deck-Med (28 SF);
 Additions 2 Story Frame (410 SF) (410 Bsmt SF);
 Garages 840 SF (30F W x 28F L) - Det Frame (Built 2016);
 Basement Stall - 1 stall;
 Main Area Square Feet 1129

Permits

Permit #	Date	Description	Amount
16-02716	04/07/2016	Res Addn/Int-Remodel	55,000

Valuation

	2020	2019	2018	2017
Classification	Residential	Residential	Residential	Residential
+ Assessed Land Value	\$47,000	\$50,760	\$47,000	\$47,000
+ Assessed Building Value	\$0	\$0	\$0	\$0
+ Assessed Dwelling Value	\$176,100	\$189,972	\$164,000	\$164,000
= Gross Assessed Value	\$223,100	\$240,732	\$211,000	\$211,000
- Exempt Value	\$0	\$0	\$0	\$0
= Net Assessed Value	\$223,100	\$240,732	\$211,000	\$211,000

Sioux City Special Assessments and Fees

[Click here to view special assessment information for this parcel.](#)

Sioux City Tax Credit Applications

[Apply for Homestead, Military or Business Property Tax Credits](#)

Photos**Sketches**

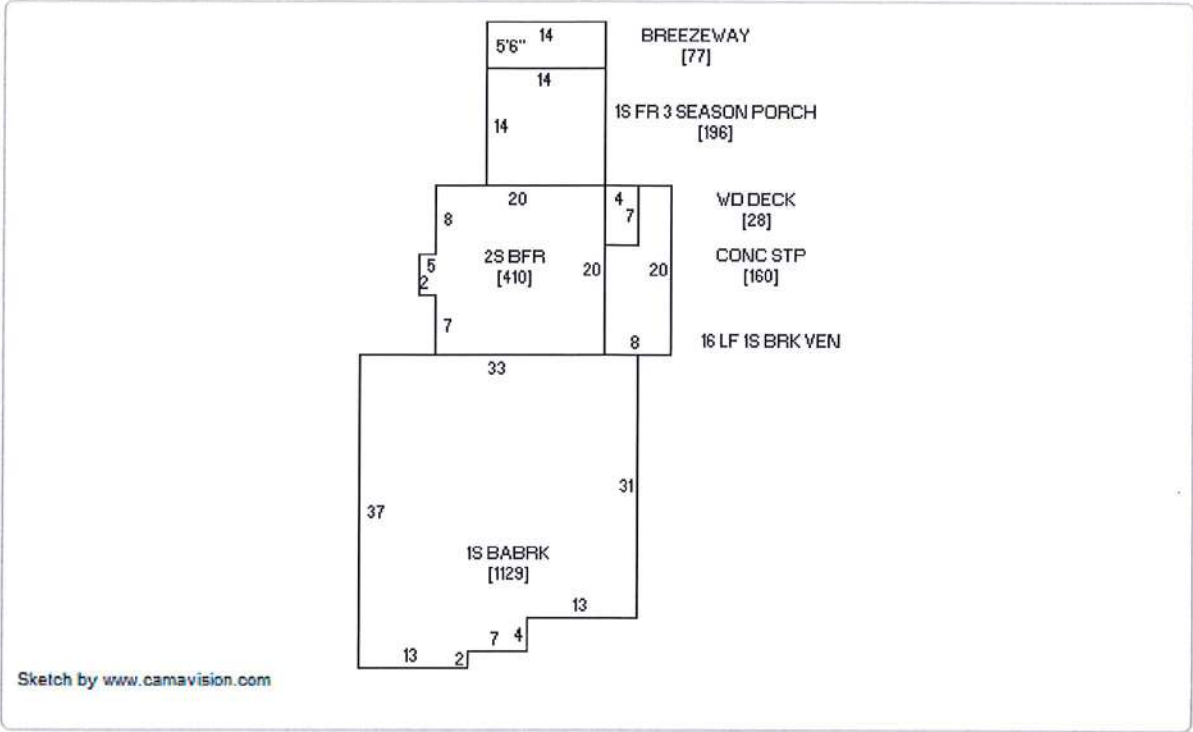

No data available for the following modules: Commercial Buildings, Agricultural Buildings, Yard Extras, Sales, Valuation History (Sioux City), Woodbury County Tax Credit Applications.

The maps and data available for access at this website are provided "as is" without warranty or any representation of accuracy, timeliness, or completeness. There are no warranties, expressed or implied, as to the appropriate use of the maps and data or the fitness for a particular purpose. The maps and associated data at this website do not represent a survey. No liability is assumed for the accuracy of the data delineated on any map, either expressed or implied.

[User Privacy Policy](#)
[GDPR Privacy Notice](#)

Developed by

