

Soils Map

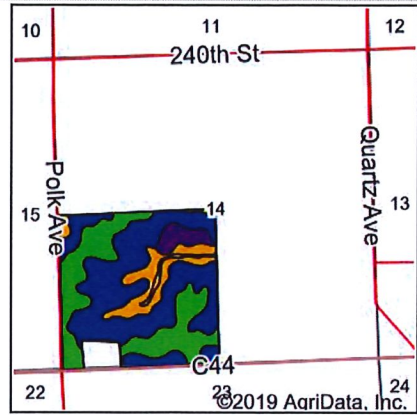

State: **Iowa**
 County: **Plymouth**
 Location: **14-91N-44W**
 Township: **Union**
 Acres: **153.7**
 Date: **8/30/2019**

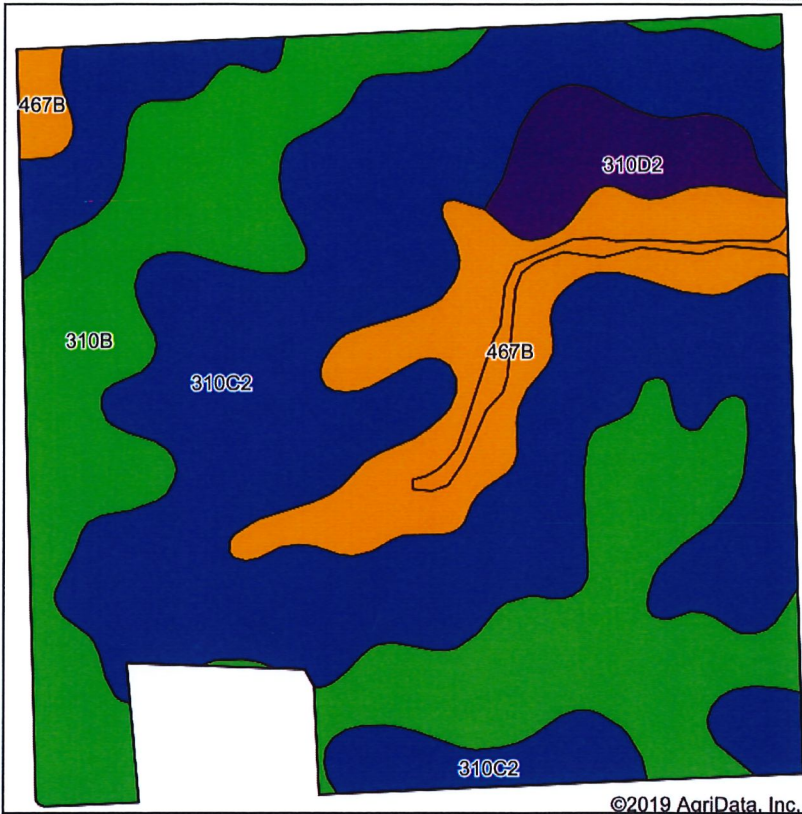

Soils data provided by USDA and NRCS.

©2019 AgriData, Inc.

Area Symbol: IA149, Soil Area Version: 29

| Code | Soil Description | Acres | Percent of field | CSR2 Legend | Non-Irr Class *c | CSR2** | CSR | *n NCCPI Soybeans |
|-------------------------|---|-------|------------------|-------------|------------------|-------------|-------------|-------------------|
| 310C2 | Galva silty clay loam, 5 to 9 percent slopes, eroded | 79.30 | 51.6% | | IIIe | 84 | 51 | 61 |
| 310B | Galva silty clay loam, 2 to 5 percent slopes | 47.91 | 31.2% | | Ile | 95 | 68 | 74 |
| 467B | Radford silty clay loam, 2 to 5 percent slopes | 19.76 | 12.9% | | Ile | 75 | 72 | 82 |
| 310D2 | Galva silty clay loam, 9 to 14 percent slopes, eroded | 6.73 | 4.4% | | IIIe | 57 | 42 | 56 |
| Weighted Average | | | | | | 85.1 | 58.6 | *n 67.5 |

**IA has updated the CSR values for each county to CSR2.

*n: The aggregation method is "Weighted Average using major components"

*c: Using Capabilities Class Dominant Condition Aggregation Method

Soils data provided by USDA and NRCS.