

Soils Map

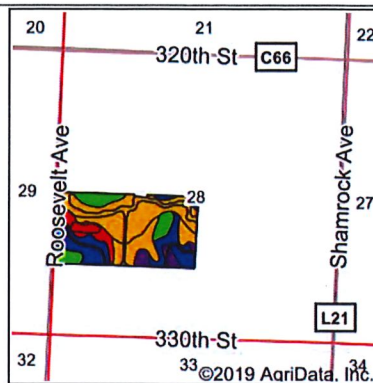

State: Iowa
 County: Plymouth
 Location: 28-90N-43W
 Township: Garfield
 Acres: 78.77
 Date: 6/4/2019

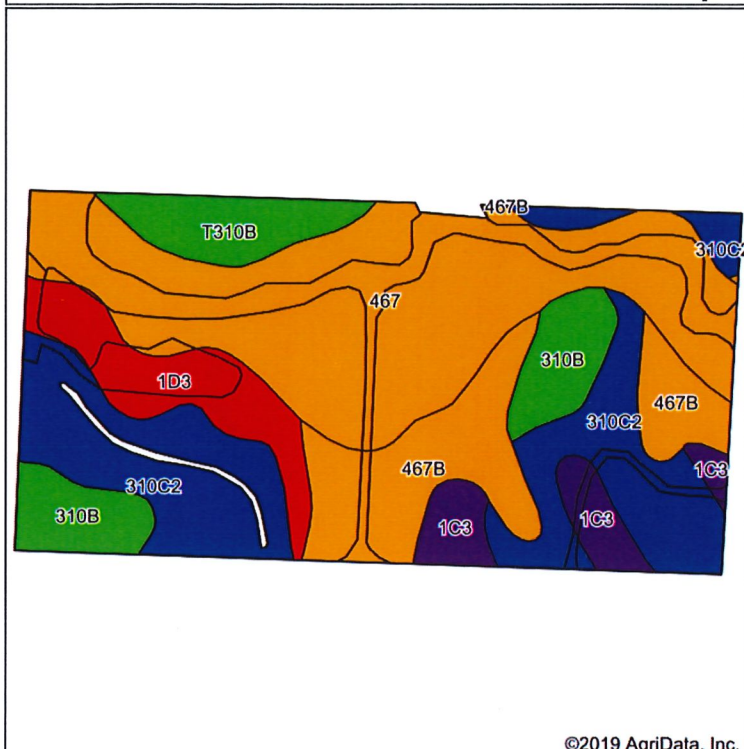

Soils data provided by USDA and NRCS.

©2019 AgriData, Inc.

Area Symbol: IA149, Soil Area Version: 29

Code	Soil Description	Acres	Percent of field	CSR2 Legend	Non-Irr Class *c	CSR2**	CSR	*n NCCPI Soybeans
467	Radford silty clay loam, 0 to 2 percent slopes	28.83	36.6%		Iw	79	74	83
310C2	Galva silty clay loam, 5 to 9 percent slopes, eroded	18.83	23.9%		IIle	84	51	61
467B	Radford silty clay loam, 2 to 5 percent slopes	10.92	13.9%		Ile	75	72	82
1D3	Ida silt loam, 9 to 14 percent slopes, severely eroded	6.31	8.0%		IIle	32	35	47
310B	Galva silty clay loam, 2 to 5 percent slopes	6.12	7.8%		Ile	95	68	74
T310B	Galva silty clay loam, terrace, 2 to 5 percent slopes	3.92	5.0%		Ile	95	69	75
1C3	Ida silt loam, 5 to 9 percent slopes, severely eroded	3.84	4.9%		IIle	58	44	49
Weighted Average						76.9	62.9	*n 72

**IA has updated the CSR values for each county to CSR2.
 *n: The aggregation method is "Weighted Average using major components"
 *c: Using Capabilities Class Dominant Condition Aggregation Method

Soils data provided by USDA and NRCS.