

### Soils Map

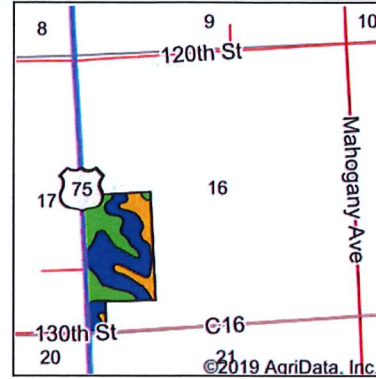

State: Iowa  
 County: Plymouth  
 Location: 16-93N-45W  
 Township: Elgin  
 Acres: 67.81  
 Date: 5/10/2019



Maps Provided By:  
  
 © AgriData, Inc. 2019 www.AgriDataInc.com



Soils data provided by USDA and NRCS.

Area Symbol: IA149, Soil Area Version: 29

Code	Soil Description	Acres	Percent of field	CSR2 Legend	Non-Irr Class *c	CSR2**	CSR	*n NCCPI Soybeans
310C2	Galva silty clay loam, 5 to 9 percent slopes, eroded	34.35	50.7%		IIIe	84	51	61
310B	Galva silty clay loam, 2 to 5 percent slopes	21.17	31.2%		Ile	95	68	74
467B	Radford silty clay loam, 2 to 5 percent slopes	12.29	18.1%		Ile	75	72	82
<b>Weighted Average</b>						<b>85.8</b>	<b>60.1</b>	<b>*n 68.9</b>

\*\*IA has updated the CSR values for each county to CSR2.  
 \*n: The aggregation method is "Weighted Average using major components"  
 \*c: Using Capabilities Class Dominant Condition Aggregation Method  
Soils data provided by USDA and NRCS.